

# ORIGINAL

## RESOLUTION NO. 223

### A RESOLUTION OF THE CITY OF SHORELINE, WASHINGTON AUTHORIZING PARKING RESTRICTIONS ON PORTIONS OF NW 159<sup>TH</sup> ST 1<sup>ST</sup> AVE NW, PALATINE AVE N AND N 160<sup>TH</sup> IN THE VICINITY OF SHORELINE COMMUNITY COLLEGE, AND ESTABLISHING A RESIDENTIAL PARKING PERMIT ZONE

WHEREAS, residents of the Highland Terrace neighborhood have submitted petitions to the City to form a Residential Parking Zone (RPZ) on their streets which satisfy the RPZ criteria approved by the Council as part of the Neighborhood Traffic Safety Program; and

WHEREAS, additional two-hour parking limits should be placed on portions of N. 160<sup>th</sup> St and 1<sup>st</sup> Ave. NW to provide additional residential on-street parking outside the RPZ zone; and

WHEREAS, the State Model Traffic Ordinance adopted by the City authorizes the City Council to pass a resolution regulating or limiting parking on any highway at all times or during such times as shall be indicated by official traffic control devices, after an engineering and traffic investigation by the Traffic Engineer (WAC 308-330-270(7); and

WHEREAS the Traffic Engineer has surveyed on street parking in the proposed RPZ and advised that parking generated by Shoreline Community College has removed in excess of 75% of on-street parking spaces available for adjacent residences during certain peak hours; and

WHEREAS, the Traffic Engineer is authorized to establish loading zones (WAC 308-330-265(14); **NOW THEREFORE,**

**BE IT RESOLVED BY THE CITY COUNCIL OF THE CITY OF SHORELINE AS FOLLOWS:**

**Section 1. Residential Parking Zone Established.** A residential parking zone (RPZ), designated Zone 1, is hereby established for those portions of NW 159<sup>th</sup> ST., 1<sup>st</sup> Ave. NW, and Palatine Ave N. depicted on the map attached hereto as Exhibit A and incorporated herein. Parking shall be prohibited in the zone between the hours of 8 a.m. and 1 p.m. except Saturday, Sunday and holidays unless the parked vehicle displays a Zone 1 parking permit issued by the City according to the procedures adopted in the Neighborhood Traffic Safety Program. The traffic engineer is directed to post signs establishing the zone parking restrictions as soon as practicable after property owners have received at least two weeks notice that zone permits are available.

**Section 2. Parking Restrictions Adopted.** Parking shall be prohibited, or restricted to two hours between the hours of 8 a.m. and 1 p.m., on the portions of N 160<sup>th</sup> St and 1<sup>st</sup> Ave NW indicated on Exhibit A.

**Section 3. Adjustment of Time Restrictions Authorized.** The Traffic Engineer is authorized to make adjustments in the parking restrictions adopted in this resolution based on surveys of on-street space availability on the streets included herein, which adjustments, in the

JAN 10 1970

judgment of the Engineer, are needed to maintain the availability of 25% of on-street parking spaces during the hours of 8 a.m. to 6 p. m.

**ADOPTED BY THE CITY COUNCIL ON SEPTEMBER 13, 2004.**

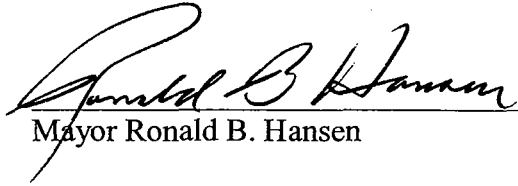
  
\_\_\_\_\_  
Mayor Ronald B. Hansen

**ATTEST:**

  
\_\_\_\_\_  
Sharon Mattioli, City Clerk



## Highland Terrace Residential Parking Zone

Proposed Locations of Parking Restrictions

### Legend

			Marked Crosswalk

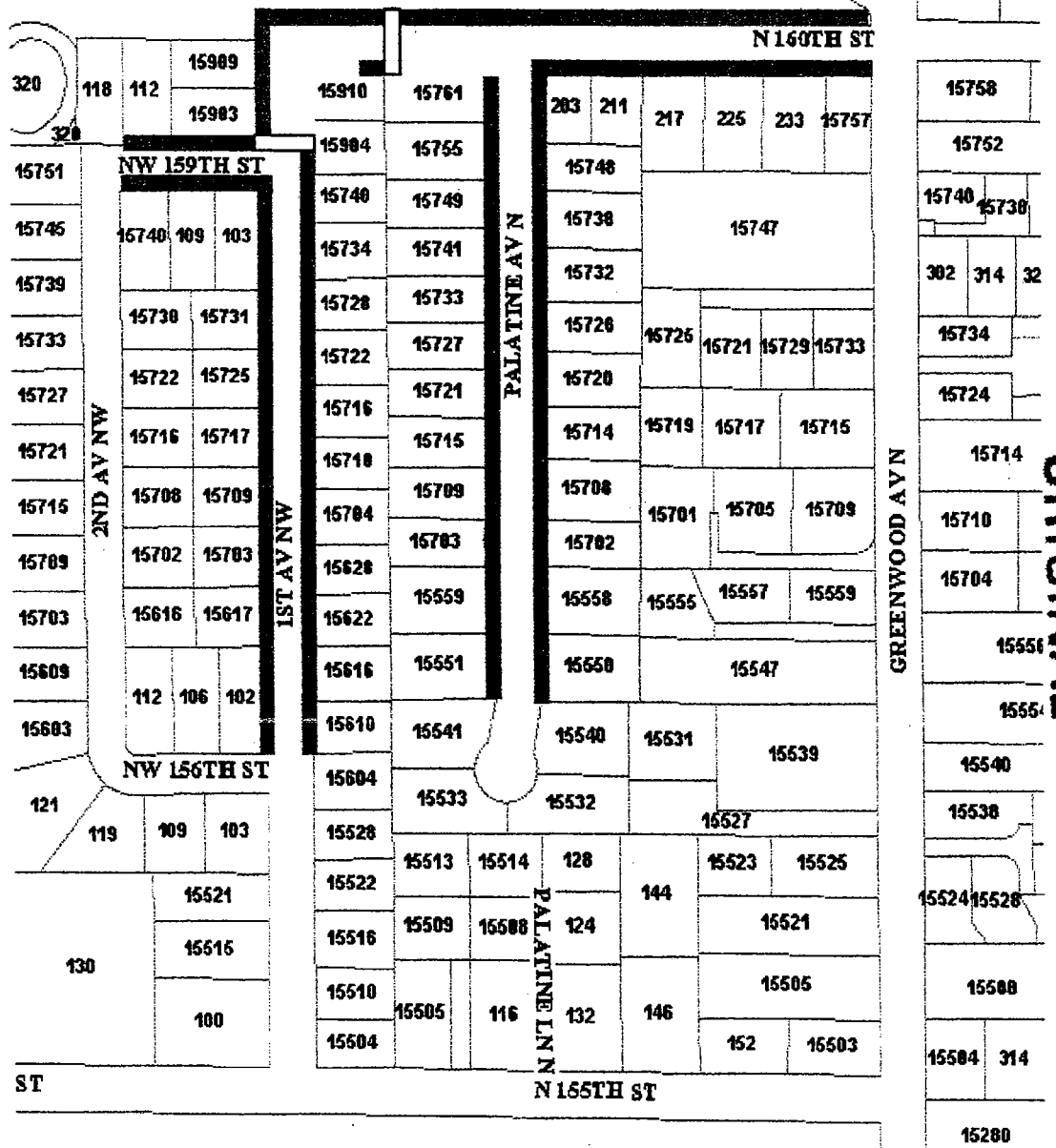

ORIGINAL

09