

BUILDING DATA			NOTE: PER IFC TABLE 2306.2.3 AND IBC SECTION 406.7.2 FUEL TANKS ARE MINIMUM 5'-0" FROM BUILDING B
BUILDING A	BUILDING B	BUILDING C	
GROSS AREA: 1,891 SQ. FT.	GROSS AREA: 843 SQ. FT.	GROSS AREA: 2,262 SQ. FT.	
CONSTRUCTION TYPE: IIB & IV	CONSTRUCTION TYPE: IIB	CONSTRUCTION TYPE: IIB	
OCCUPANCY: B	OCCUPANCY: B	OCCUPANCY: S-2	

GROSS AREA CALCULATIONS		
Number	Name	Actual Area
A100	BREAK ROOM	212 SF
A101	STORAGE	49 SF
A102	TOILET	56 SF
A103	SNOW & ICE TOOL STORAGE	115 SF
A104	UTILITY ROOM	392 SF
A105	MANUAL WASH BAY	1,067 SF
B100	SNOW & ICE STORAGE	Not Placed
B101	ENCLOSED BAY	Not Placed
C100	FUELING AREA	843 SF
C104	SALT STORAGE	1,018 SF
C105	DECANT WW	561 SF
C106	DECANT SPOILS	963 SF
TOTAL		5,275 SF

LEGEND	
OCCUPANCY USE BUSINESS - B	
OCCUPANCY USE STORAGE - S-2	
FIRE EXTINGUISHER	
1-HOUR FIRE WALL	
PROPERTY LINE	



Project Title
**CITY OF SHORELINE
BALLINGER
MAINTENANCE
FACILITY**

Project Numbers
2019-009

Issue & Revision Dates		
20 JULY 2020	PRE-APP SET	
24 JULY 2020	75% SD PROGRESS SET	
28 AUG 2020	100% SD SET	
6 OCT 2020	50% DD PROGRESS SET	
30 OCT 2020	75% DD PROGRESS SET	
7 JUNE 2021	100% DD SET	

DESIGN DEVELOPMENT
NOT FOR CONSTRUCTION

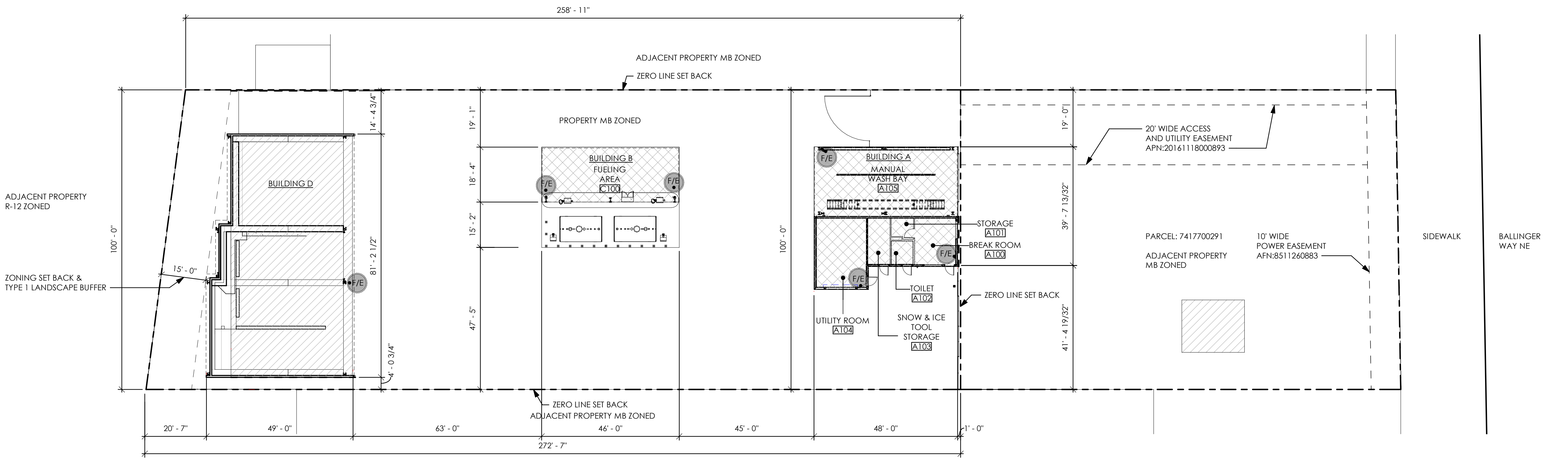

A SITE GROSS AREA, OCCUPANCY & EXIT CODE
1" = 20'-0"



6/8/2021 1:45:17 PM C:\Revit\2021\909 Arch_DD_Gemmoddy.rvt

Sheet Title
**SITE GROSS
AREA,
OCCUPANCY
& EXIT CODE
PLAN**

Drawn By: MM Checked By: MH

Sheet Number

G2.03

Sheet Number Of
All material herein constitutes the original and unpublished work of the architect and may not be used, duplicated or disclosed without the written consent of the architect. Copyright © 2020 by TCF Architecture, PLLC. All rights reserved.