



Construction alert

Steel pole foundation work on NE 200th Street East of 6th Avenue

Starting as early as August 12th Sound Transit will reduce part of NE 200th St East of 6th Avenue NE to one inside lane as part of the Lynnwood Link Extension early work construction. Sound Transit and Seattle City Light will be working to set the new steel poles and raise utility lines in order to provide clearance for the guideway construction.

[More details](#)

Contact us

Outreach Specialist: My Nguyen, my.nguyen@soundtransit.org or 206-370-5690.

After-hours construction hotline: 888-298-2395

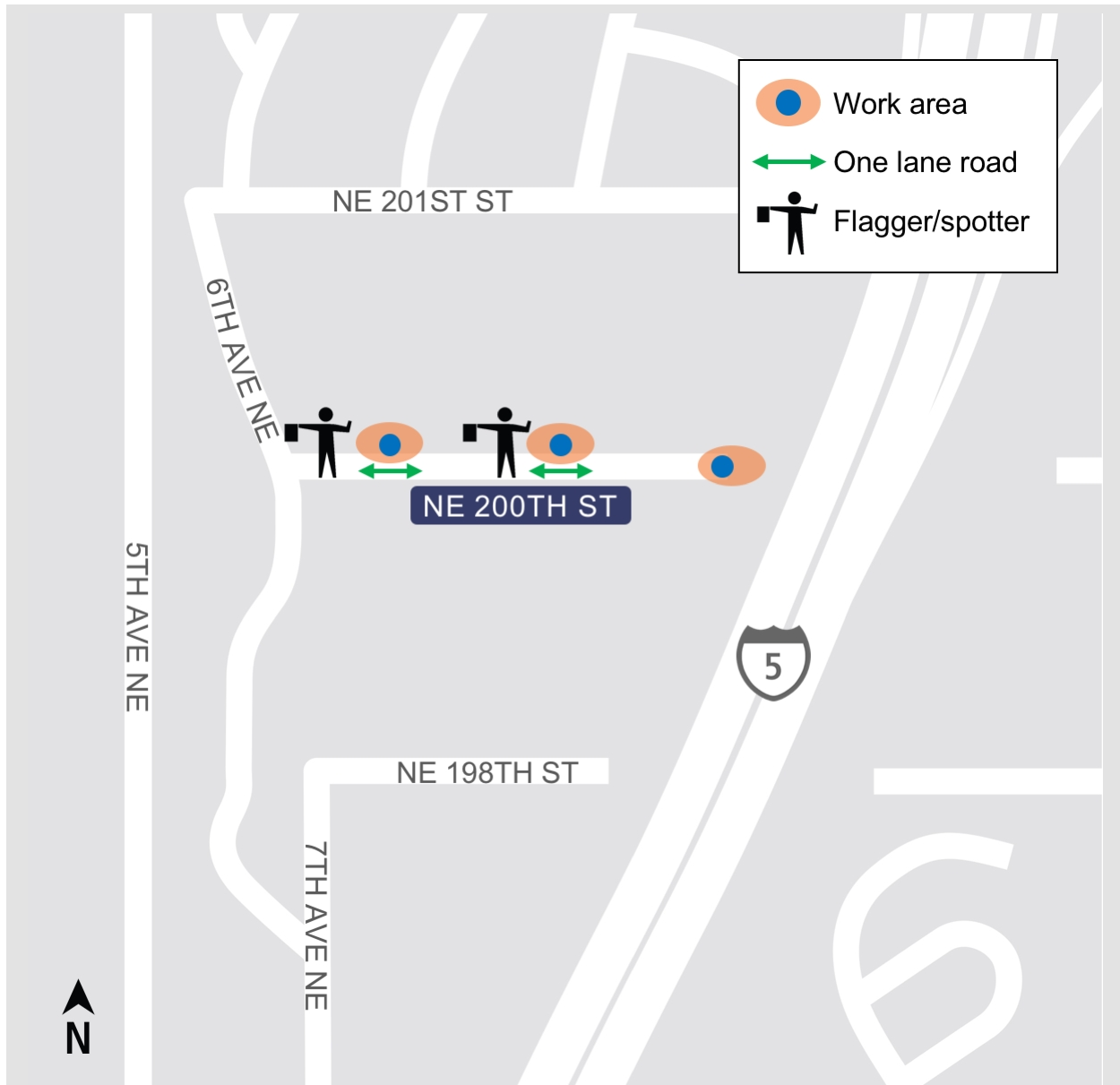

Stay ahead of construction

Your safety is our priority. Learn how to [stay safe](#) around our construction sites.

Watch for future alerts and project updates. Forward this to your friends, family, neighbors, and people in your community! Encourage them to [subscribe](#).

How it's built

24-hour construction hotline: 888-298-2395

More project info: soundtransit.org/le

Questions? lynnwoodlink@soundtransit.org or 206-398-5300

New to Sound Transit? [Learn more](#)

Subscription options

You are receiving this email because you are subscribed to a Sound Transit newsletter.

[Unsubscribe](#) | [Edit Subscription Preferences](#)

Contact us

Union Station, 401 S. Jackson St., Seattle, WA 98104 | 1-800-201-4900/ TTY Relay: 711 |

soundtransit.org | [Customer service](#) | [Website feedback](#)

To request accommodations for persons with disabilities, call 1-800-201-4900/ TTY Relay: 711 or e-mail accessibility@soundtransit.org.

Languages:

[中文](#) | [Chinese](#) | [한국](#) | [Korean](#) | [Русский](#) | [Russian](#) | [Español](#) | [Spanish](#) | [Tagalog](#) | [Tiếng việt](#) | [Vietnamese](#)