

NOTICING MATERIALS:  
PROJECT SUP NOTICES,  
DECLARATIONS OF MAILING,  
NOTICING AREA MAP, AND  
SIGN LOCATIONS MAP

- \* Notice of Application 9/24/2018 with Vicinity Map and Site Plans (Post)
- \* Declaration of Mailing
- \* Notice of Application 9/24/2018 (Paper)
- \* Affidavit of Publication
- \* Re-Notice of Application 10/3/2018 with Vicinity Map and Site Plans (Post)
- \* Re-Notice of Application 10/3/2018 (Paper)
- \* Declaration of Mailing Re-Notice 10/3/2018
- \* Notice Area Map
- \* Noticing Area and Sign Locations



## Notice of Special Use Permit Application

September 24, 2018

**Name of Applicant and Application No.:** Central Puget Sound Regional Transit Authority (Sound Transit), application #SPL 18-0140.

**Location & Description of Project:** The new Lynnwood Link Extension Light Rail Transit Project (Project) facilities and systems are proposed to be located within Shoreline on the east side of I-5, paralleling I-5, beginning from the southern City limits at NE 145<sup>th</sup> Street, extending north to the northern City limits by State Route 104/NE 205<sup>th</sup> Street. Sound Transit has requested a special use permit, including code modifications, engineering deviations, and administrative design reviews. The proposal is to construct an approximately 3.2 mile segment, including two stations, of the Lynnwood Link Extension Light Rail Transit Project facilities and systems within the City of Shoreline.

**Application Submitted & Complete:** August 16, 2018

**Project Manager Name & Phone No.:** Jennifer K. Wells, CSBA, Senior Planner, 206-801-2528

**Project Information:** The Light Rail Transit facilities and systems will consist of light rail tracks mainly located on at-grade or retained fill guideway, with four areas of elevated guideway - entering Shoreline over NE 145<sup>th</sup> Street, over NE 155<sup>th</sup> Street and NE 175<sup>th</sup> Street, and exiting Shoreline over NE 205<sup>th</sup> Street (SR 104); two stations - one at NE 148<sup>th</sup> Street and one at NE 185<sup>th</sup> Street - each with a bus transit center and related amenities; two parking garages, noise walls, and operations structures.

Total Project Area: The Light Rail Transit Guideway is approximately 3.2 miles long and 35 feet wide; the site for the Shoreline South/145<sup>th</sup> Station and Parking Garage is about 185,000 square feet (~4.2 acres); and the site for the Shoreline North/185<sup>th</sup> Station and Parking Garage is approximately 220,000 square feet (5.0 acres).

Station Areas Zoning: Mixed-Use Residential - MUR-70'

Light Rail Transit Corridor Zoning: Low Density Residential - R-6; High Density Residential - R-24; Mixed-Use Residential - MUR-70', MUR-45', MUR-35'

**Environmental Review:** Sound Transit is the SEPA Lead Agency for the Project. Sound Transit issued the Lynnwood Link Extension Final Environmental Impact Statement (FEIS) on April 1, 2015 and the 2018 SEPA Addendum on May 3, 2018. This environmental review covers the City's issuance of permits for the Project, as well as environmental mitigation. The Project is also subject to environmental review under the National Environmental Policy Act (NEPA). The Federal Transit Administration (FTA), acting as the Federal NEPA Lead Agency, issued its Lynnwood Link Extension Record of Decision (ROD) on July 10, 2015. The Federal Highway Administration (FHWA), as a cooperating agency under NEPA, issued its Record of Decision on August 31, 2015. The FHWA's ROD addresses elements of the Project affecting interstate right-of-way requiring FHWA approvals. The Application includes a summary of applicable mitigation measures contained in these RODs.

**Public Comment:** The 21-day public comment period ends October 15, 2018 at 5:00 p.m., interested persons are encouraged to mail or deliver comments to City of Shoreline, Attn: Jennifer K. Wells, 17500 Midvale Avenue N, Shoreline, WA 98133; fax (206) 801-2788; or email to [jwells@shorelinewa.gov](mailto:jwells@shorelinewa.gov).

**17500 Midvale Avenue N, Shoreline, Washington 98133-4905**  
Telephone (206) 801-2500 Fax (206) 801-2788 [pcd@shorelinewa.gov](mailto:pcd@shorelinewa.gov)

**Open Record Public Hearing:** Interested parties are also encouraged to participate in a public hearing which will be scheduled before the Hearing Examiner. A separate notice of public hearing will be mailed and posted on the City's website once the hearing is scheduled.

**Development Regulations Used:** Current editions of Shoreline Municipal Code and Comprehensive Plan, Engineering Development Manual, Parks, Recreation and Cultural Services Plan, Surface Water Master Plan, Transportation Master Plan, and Department of Ecology Stormwater Management Manual for Western Washington. All documents are available for review at the City Hall, 17500 Midvale Avenue N.

**Environmental Documents Submitted:** 2015 Lynnwood Link Extension FEIS; 2018 LLE SEPA Addendum to the FEIS; Critical Areas Report including Critical Areas Assessments for all types of critical areas and Mitigation Plans for all impacted critical areas; Draft Tree Removal and Mitigation Report; LLE IP90pct Tree Inventory Update; L200 Station Area Access Assessment Report; Multimodal Access Assessment and Mitigation Plan; Draft Sustainability Report; L200 90pct Draft Sustainability Checklist; L200 IP90pct Noise, Vibration and Groundborne Noise Report; L200 100pct Construction Noise, Vibration and Groundborne Noise Report; L200 Traffic Engineering Report; and L200 IP90pct Traffic Analysis Update Memorandum.

**Other Required City Permits:** Critical Areas Special Use Permits, Street Vacation Petition(s), Floodplain Development Permits, Noise Variances, Lot Line Adjustment/Lot Merger Permits, Demolition Permits, Site Development Permits, Right-of-Way Use Permits, Building Permits, Miscellaneous Structure Permits, Mechanical Permits, Plumbing Permits, Wastewater Permits, Fire System Permits, and Sign Permits.

Copies of the full notice of application, application materials, and applicable codes are available for review at the City Hall, 17500 Midvale Avenue North.

#### **NOTICE OF DISCLOSURE**

The City of Shoreline will enter all comments received into the public record and may make these comments, and any attachments or other supporting materials, available unchanged, including any business or personal information (name, email address, phone, etc.) that you provide available for public review. This information may be released on the City's website. Comments received are part of the public record and subject to disclosure under the Public Records Act, RCW 42.56. Do not include any information in your comment or supporting materials that you do not wish to be made public, including name and contact information.

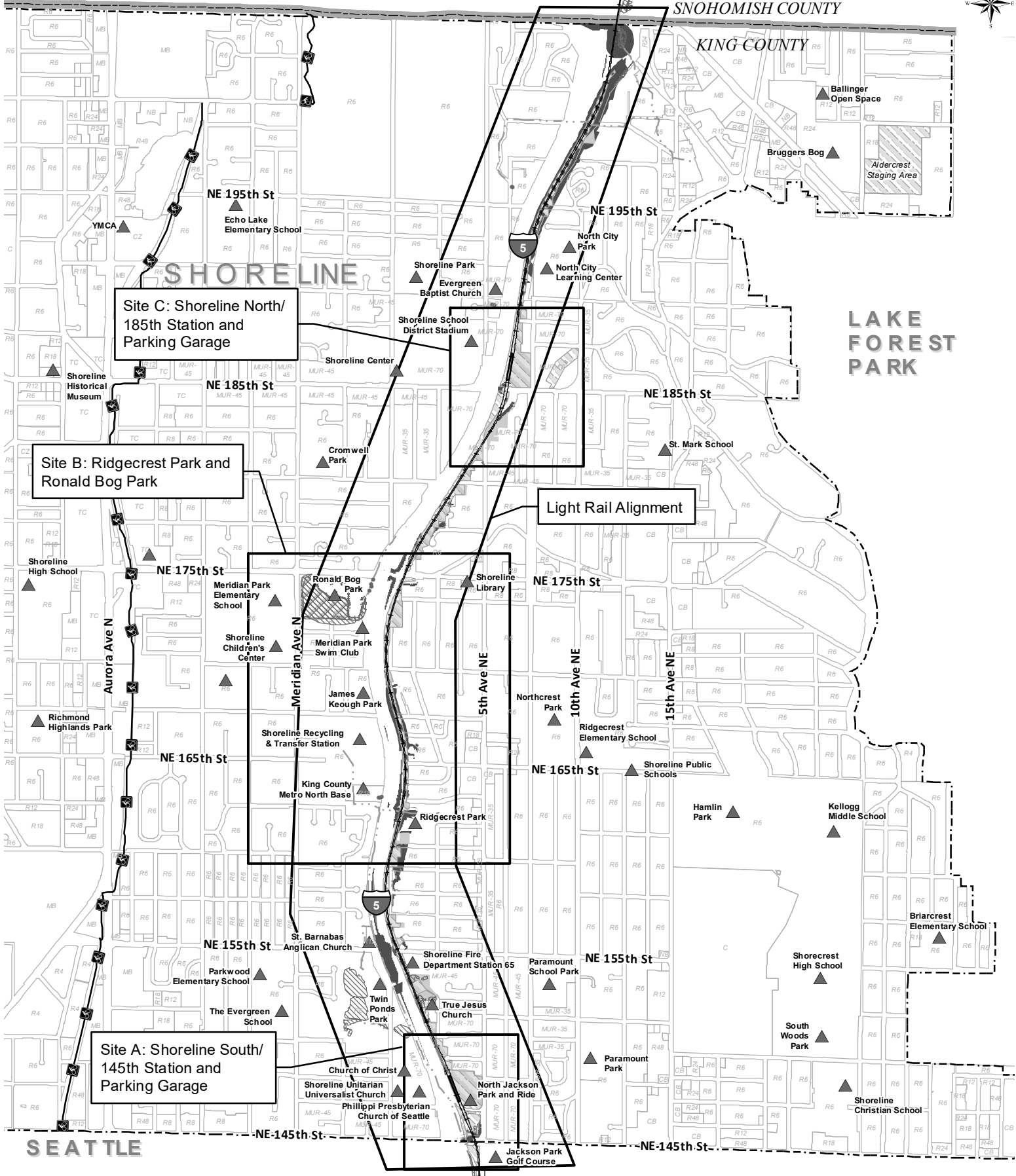

Site C: Shoreline North/  
185th Station and  
Parking Garage

Site B: Ridgcrest Park and  
Ronald Bog Park

Site A: Shoreline South/  
145th Station and  
Parking Garage

Light Rail Alignment

**Legend**

- ▲ Points of Interest
- Station Platform
- ▭ Site Plan Callout
- ▨ Waterbody
- ▧ City Boundaries
- ▩ Construction Staging Areas
- ⚡ Interurban Trail
- Light Rail Alignment
- ▨ Wetlands
- ▨ Zoning Boundaries
- ▩ County Boundaries
- Stream
- ▨ Proposed Acquisitions
- Swale
- ▨ Moderately High Landslide Hazard Areas
- ▨ Very High Landslide Hazard Areas

0 0.25 0.5 Miles

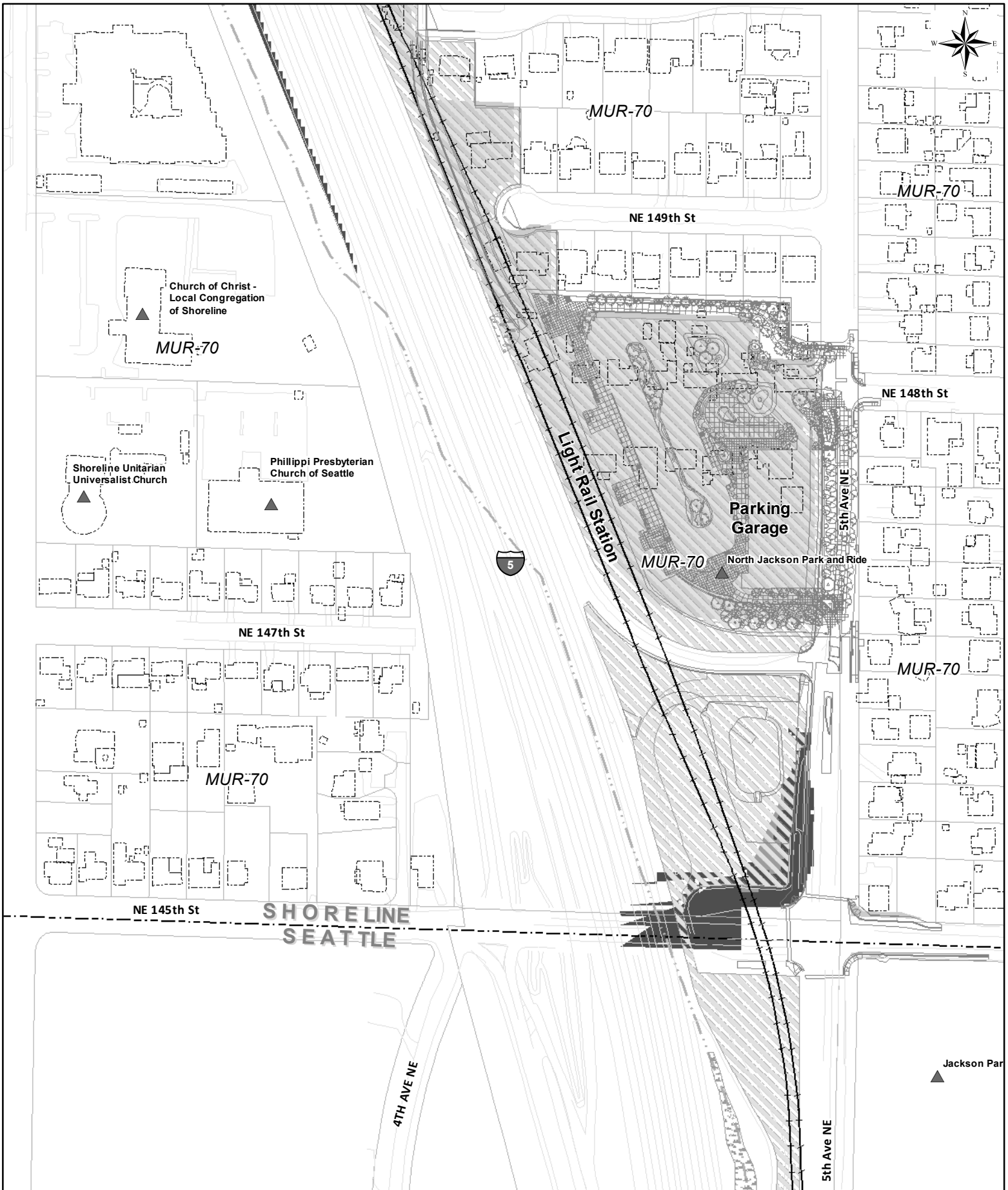

**Site Plan A - Shoreline South/145th Station and Parking Garage**

- ▲ Points of Interest
- Proposed Project
- Light Rail
- Existing Roads
- Stream
- Wetland
- ▨ Waterbody
- ▨ Swale
- ▨ City Boundaries
- ▨ Existing Buildings
- ▨ Parcels
- ▨ Proposed Acquisitions

- R6 Zoning
- ▨ Construction Staging Areas
- ▨ Moderately High Landslide Hazard Areas
- ▨ Very High Landslide Hazard Areas

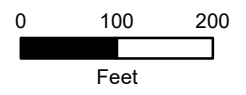

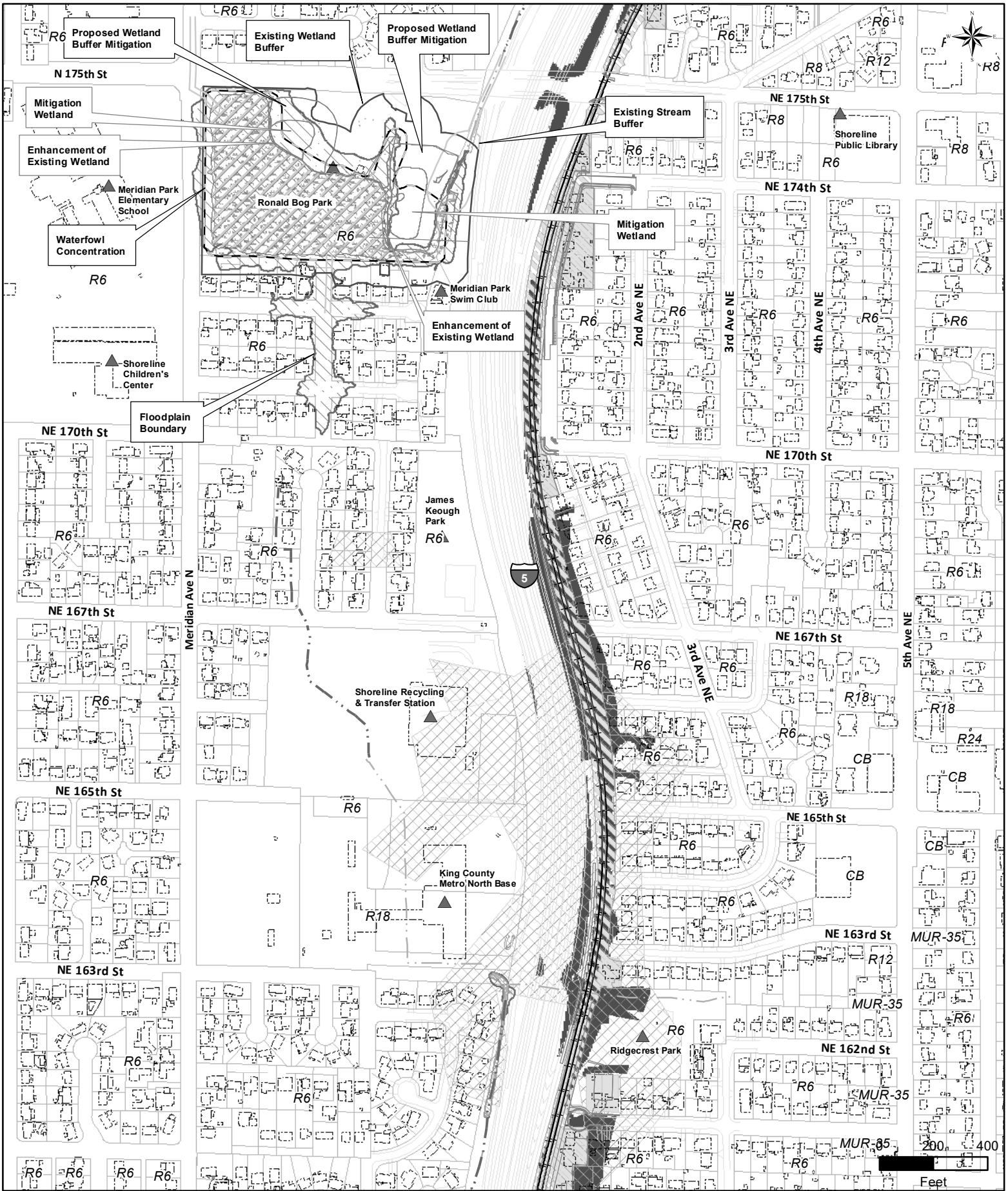

**Site Plan B - Ridgcrest Park and Ronald Bog Park**

- |                      |                         |                   |                                  |   |  |
|----------------------|-------------------------|-------------------|----------------------------------|---|--|
| ▲ Points of Interest | --- Stream              | ▨ Wetland         | ▭ Existing Buildings             | ▭ Priority Habitat and Species (PHS) Area | ▨ Moderately High Landslide Hazard Areas |
| — Light Rail         | --- Site Stream Line    | ▨ Waterbody       | ▭ Parcels                        | ▨ FEMA Designated Floodway                | ▨ Very High Landslide Hazard Areas       |
| — Proposed Project   | --- Site Stream Buffer  | ▨ Swale           | ▭ Proposed Acquisitions          | ▨ FEMA 100 Year Floodplain                | R6 Zoning                                |
| — Existing Roads     | --- Site Wetland Buffer | ▭ City Boundaries | ▨ Potential Erosion Hazard Soils | ▨ Construction Staging Areas              |  |

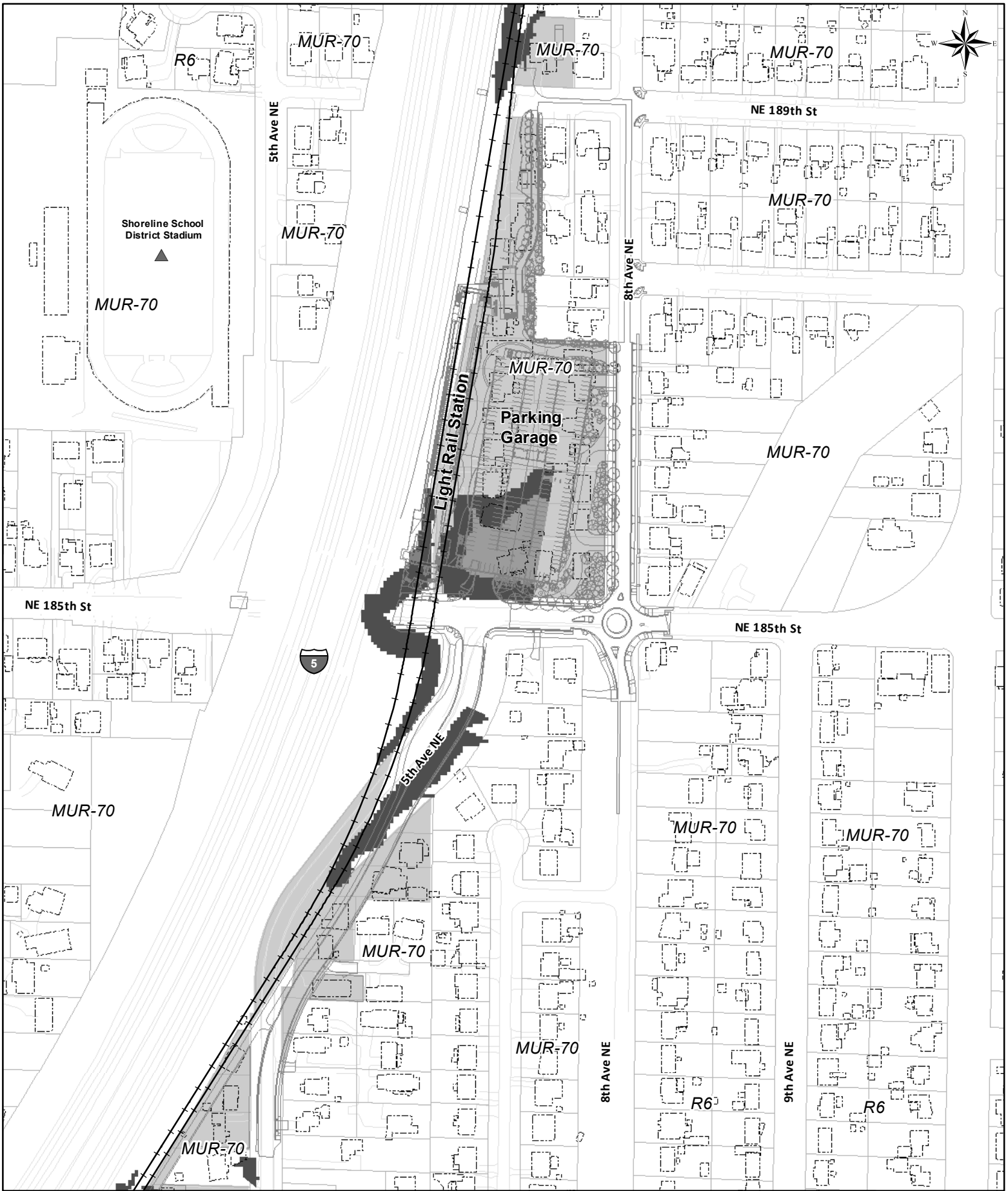

**Site Plan C - Shoreline North/185th Station and Parking Garage**

▲ Points of Interest	— Existing Roads	▨ Waterbody	▭ Existing Buildings	▨ Construction Staging Areas
— Light Rail	- - - Stream	▨ Swale	▭ Parcels	▨ Moderately High Landslide Hazard Areas
— Proposed Project	▨ Wetlands	▭ City Boundaries	▨ Proposed Acquisitions	▨ Very High Landslide Hazard Areas

R6 Zoning  
 0 100 200 Feet





ANN  
MIGDAL

17500 Midvale Avenue North  
Shoreline, WA 98133-4905  
(206) 801-2500

## DECLARATION OF MAILING

I, Bob Ryburn, Account Representative, Arctic Printing and Graphics, Inc., declare the following:

I am over the age of 18, a resident of Washington State and have no interest in the proposal described in the attached notice. I certify that I mailed a true and correct copy of the attached notice to recipients on the attached list, postage prepaid, on SEPT 24, 2018.

Bob Ryburn  
Signature

Dated this 25 day of SEPT, 2018 at Shoreline, Washington



Project #: PLN18-0140

## **The City of Shoreline Notice of Special Use Permit Application**

**Location:** The new Lynnwood Link Extension Light Rail Transit Project facilities and systems are located within Shoreline on the east side of I-5, paralleling I-5, beginning from the southern City limits at NE 145<sup>th</sup> Street, extending northern to the north City limits by State Route 104/NE 205<sup>th</sup> Street. **Application No.:** SPL18-0140.

**Type of Permit(s) Required:** Critical Areas Special Use Permits, Street Vacation Petition(s), Floodplain Development Permits, Noise Variances, Lot Line Adjustment/Lot Merger Permits, Demolition Permits, Site Development Permits, Right-of-Way Use Permits, Building Permits, Miscellaneous Structure Permits, Mechanical Permits, Plumbing Permits, Wastewater Permits, Fire System Permits, and Sign Permits.

**Project Description:** Sound Transit has requested a special use permit to construct an approximately 3.2 mile segment of the Lynnwood Link Extension Light Rail Transit Project facilities and systems, including two stations, within the City of Shoreline.

The public comment period ends **October 15, 2018** at 5:00 p.m. Please Public Comment: mail or deliver comments to City of Shoreline, Attn: Jennifer K. Wells, 17500 Midvale Avenue N, Shoreline, WA 98133; fax (206) 801-2788; or email to [jwells@shorelinewa.gov](mailto:jwells@shorelinewa.gov).

Copies of the full notice of application, application materials, and applicable codes are available for review at the City Hall, 17500 Midvale Avenue N.

# The Seattle Times

City of Shoreline Planning & Comm D  
Accounts Payable  
17500 Midvale Ave N

Shoreline, WA 98133-4905

Re: Advertiser Account # 100164  
Ad #: 839470

Agency Account #: 0  
Agency Name:

## Affidavit of Publication

STATE OF WASHINGTON  
Counties of King and Snohomish

The undersigned, on oath states that he/she is an authorized representative of The Seattle Times Company, publisher of The Seattle Times of general circulation published daily in King and Snohomish Counties, State of Washington. The Seattle Times has been approved as a legal newspaper by others of the Superior Court of King and Snohomish Counties.

The notice, in the exact form annexed, was published in the regular and entire issue of said paper or papers and distributed to its subscribers during all of the said period.

Newspaper and Publication Date(s)	
	
Seattle Times	09/24/18

Agent James Chung Signature 

Subscribed and sworn to before me on SEPT 24 2018  
DATE

 **Debbie Collantes**

(Notary Signature) Notary Public in and for the State of Washington, residing at Seattle

DEBBIE COLLANTES  
Notary Public  
State of Washington  
My Appointment Expires  
Feb 15 2022

# The Seattle Times

Re: Advertiser Account # 100164

Ad #: 839470

Agency Account #: 0

Agency Name:

## AD TEXT

### **The City of Shoreline Notice of Special Use Permit Application**

**Location:** The new Lynnwood Link Extension Light Rail Transit Project facilities and systems are located within Shoreline on the east side of I-5, paralleling I-5, beginning from the southern City limits at NE 145th Street, extending northern to the north City limits by State Route 104/NE 205th Street. **Application No.:** SPL18-0140.

**Type of Permit(s) Required:** Critical Areas Special Use Permits, Street Vacation Petition(s), Floodplain Development Permits, Noise Variances, Lot Line Adjustment/Lot Merger Permits, Demolition Permits, Site Development Permits, Right-of-Way Use Permits, Building Permits, Miscellaneous Structure Permits, Mechanical Permits, Plumbing Permits, Wastewater Permits, Fire System Permits, and Sign Permits.

**Project Description:** Sound Transit has requested a special use permit to construct an approximately 3.2 mile segment of the Lynnwood Link Extension Light Rail Transit Project facilities and systems, including two stations, within the City of Shoreline.

The public comment period ends October 15, 2018 at 5:00 p.m. Please Public Comment: mail or deliver comments to City of Shoreline, Attn: Jennifer K. Wells, 17500 Midvale Avenue N, Shoreline, WA 98133; fax (206) 801-2788; or email to [jwells@shorelinewa.gov](mailto:jwells@shorelinewa.gov).

Copies of the full notice of application, application materials, and applicable codes are available for review at the City Hall, 17500 Midvale Avenue N.

RECEIVED  
OCT 01 2018

PCD



## REVISED Notice of Special Use Permit Application

October 3, 2018

*This project is being re-noticed to conform to SMC 20.30.060. The comment period has been revised. All comments received during the original comment period are still valid.*

**Name of Applicant and Application No.:** Central Puget Sound Regional Transit Authority (Sound Transit), application #SPL 18-0140.

**Location & Description of Project:** The new Lynnwood Link Extension Light Rail Transit Project (Project) facilities and systems are proposed to be located within Shoreline on the east side of I-5, paralleling I-5, beginning from the southern City limits at NE 145<sup>th</sup> Street, extending north to the northern City limits by State Route 104/NE 205<sup>th</sup> Street. Sound Transit has requested a special use permit, including code modifications, engineering deviations, and administrative design reviews. The proposal is to construct an approximately 3.2 mile segment, including two stations, of the Lynnwood Link Extension Light Rail Transit Project facilities and systems within the City of Shoreline.

**Application Submitted & Complete:** August 16, 2018

**Project Manager Name & Phone No.:** Jennifer K. Wells, CSBA, Senior Planner, 206-801-2528

**Project Information:** The Light Rail Transit facilities and systems will consist of light rail tracks mainly located on at-grade or retained fill guideway, with four areas of elevated guideway - entering Shoreline over NE 145<sup>th</sup> Street, over NE 155<sup>th</sup> Street and NE 175<sup>th</sup> Street, and exiting Shoreline over NE 205<sup>th</sup> Street (SR 104); two stations - one at NE 148<sup>th</sup> Street and one at NE 185<sup>th</sup> Street - each with a bus transit center and related amenities; two parking garages, noise walls, and operations structures.

Total Project Area: The Light Rail Transit Guideway is approximately 3.2 miles long and 35 feet wide; the site for the Shoreline South/145<sup>th</sup> Station and Parking Garage is about 185,000 square feet (~4.2 acres); and the site for the Shoreline North/185<sup>th</sup> Station and Parking Garage is approximately 220,000 square feet (5.0 acres).

Station Areas Zoning: Mixed-Use Residential - MUR-70'

Light Rail Transit Corridor Zoning: Low Density Residential - R-6; High Density Residential - R-24; Mixed-Use Residential - MUR-70', MUR-45', MUR-35'

**Environmental Review:** Sound Transit is the SEPA Lead Agency for the Project. Sound Transit issued the Lynnwood Link Extension Final Environmental Impact Statement (FEIS) on April 1, 2015 and the 2018 SEPA Addendum on May 3, 2018. This environmental review covers the City's issuance of permits for the Project, as well as environmental mitigation. The Project is also subject to environmental review under the National Environmental Policy Act (NEPA). The Federal Transit Administration (FTA), acting as the Federal NEPA Lead Agency, issued its Lynnwood Link Extension Record of Decision (ROD) on July 10, 2015. The Federal Highway Administration (FHWA), as a cooperating agency under NEPA, issued its Record of Decision on August 31, 2015. The FHWA's ROD addresses elements of the Project affecting interstate right-of-way requiring FHWA approvals. The Application includes a summary of applicable mitigation measures contained in these RODs.

**Public Comment:** The 21-day public comment period ends **October 24, 2018 at 5:00 pm**, interested persons are encouraged to mail or deliver comments to City of Shoreline, Attn: Jennifer K. Wells, 17500 Midvale Avenue N, Shoreline, WA 98133; fax (206) 801-2788; or email to [jwells@shorelinewa.gov](mailto:jwells@shorelinewa.gov).

**17500 Midvale Avenue N, Shoreline, Washington 98133-4905**  
Telephone (206) 801-2500 Fax (206) 801-2788 [pcd@shorelinewa.gov](mailto:pcd@shorelinewa.gov)

**Open Record Public Hearing:** Interested parties are also encouraged to participate in a public hearing which will be scheduled before the Hearing Examiner. A separate notice of public hearing will be mailed and posted on the City's website once the hearing is scheduled.

**Development Regulations Used:** Current editions of Shoreline Municipal Code and Comprehensive Plan, Engineering Development Manual, Parks, Recreation and Cultural Services Plan, Surface Water Master Plan, Transportation Master Plan, and Department of Ecology Stormwater Management Manual for Western Washington. All documents are available for review at the City Hall, 17500 Midvale Avenue N.

**Environmental Documents Submitted:** 2015 Lynnwood Link Extension FEIS; 2018 LLE SEPA Addendum to the FEIS; Critical Areas Report including Critical Areas Assessments for all types of critical areas and Mitigation Plans for all impacted critical areas; Draft Tree Removal and Mitigation Report; LLE IP90pct Tree Inventory Update; L200 Station Area Access Assessment Report; Multimodal Access Assessment and Mitigation Plan; Draft Sustainability Report; L200 90pct Draft Sustainability Checklist; L200 IP90pct Noise, Vibration and Groundborne Noise Report; L200 100pct Construction Noise, Vibration and Groundborne Noise Report; L200 Traffic Engineering Report; and L200 IP90pct Traffic Analysis Update Memorandum.

**Other Required City Permits:** Critical Areas Special Use Permits, Street Vacation Petition(s), Floodplain Development Permits, Noise Variances, Lot Line Adjustment/Lot Merger Permits, Demolition Permits, Site Development Permits, Right-of-Way Use Permits, Building Permits, Miscellaneous Structure Permits, Mechanical Permits, Plumbing Permits, Wastewater Permits, Fire System Permits, and Sign Permits.

Copies of the full notice of application, application materials, and applicable codes are available for review at the City Hall, 17500 Midvale Avenue North.

#### **NOTICE OF DISCLOSURE**

The City of Shoreline will enter all comments received into the public record and may make these comments, and any attachments or other supporting materials, available unchanged, including any business or personal information (name, email address, phone, etc.) that you provide available for public review. This information may be released on the City's website. Comments received are part of the public record and subject to disclosure under the Public Records Act, RCW 42.56. Do not include any information in your comment or supporting materials that you do not wish to be made public, including name and contact information.

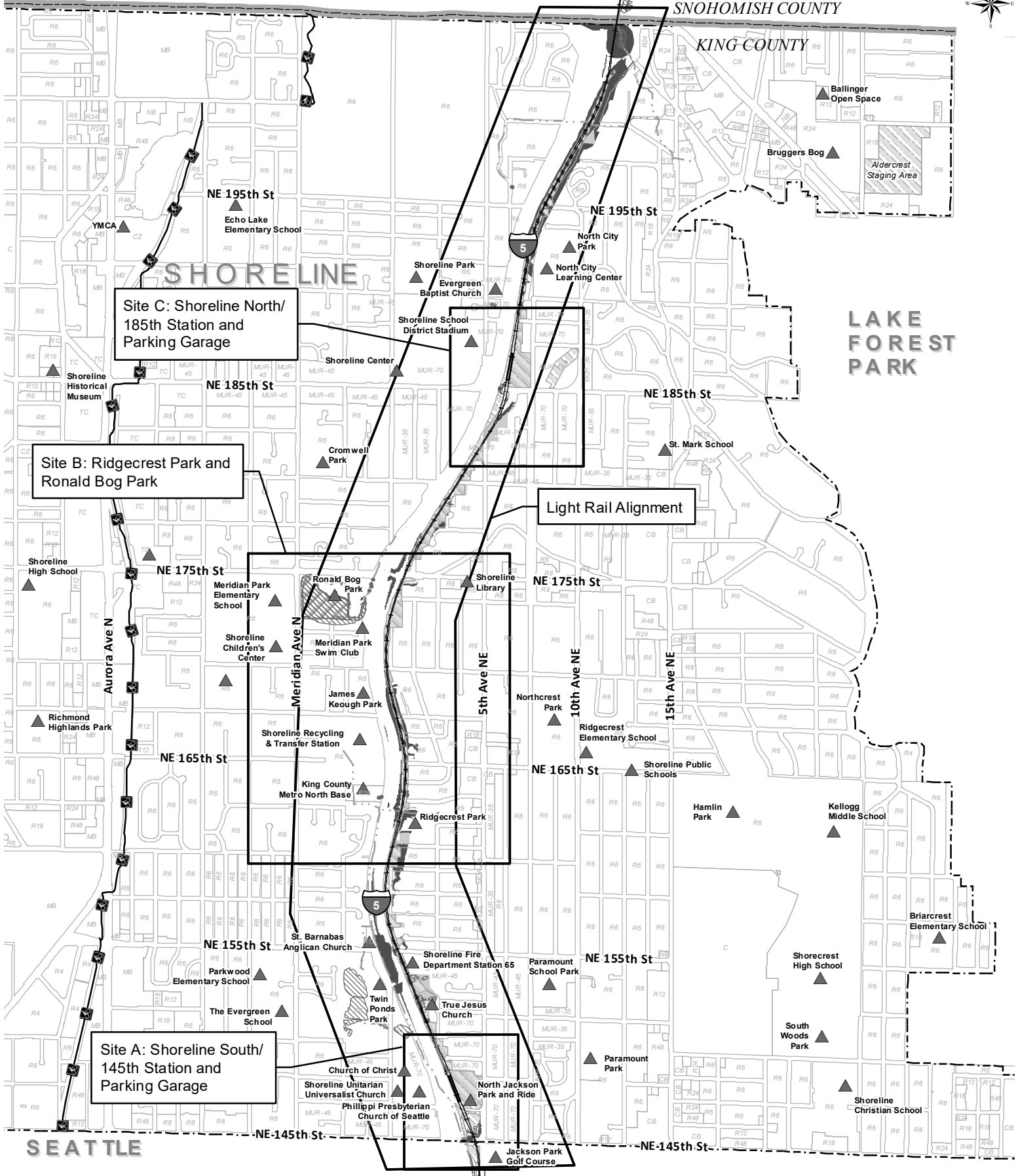

Site C: Shoreline North/  
185th Station and  
Parking Garage

Site B: Ridgcrest Park and  
Ronald Bog Park

Site A: Shoreline South/  
145th Station and  
Parking Garage

Light Rail Alignment

**Legend**

- ▲ Points of Interest
- Station Platform
- ▭ Site Plan Callout
- ▨ Waterbody
- ▧ City Boundaries
- ▧ Construction Staging Areas
- Interurban Trail
- Light Rail Alignment
- ▨ Wetlands
- ▧ Zoning Boundaries
- ▧ County Boundaries
- Stream
- ▨ Proposed Acquisitions
- Swale
- ▧ Moderately High Landslide Hazard Areas
- ▧ Very High Landslide Hazard Areas

0 0.25 0.5 Miles



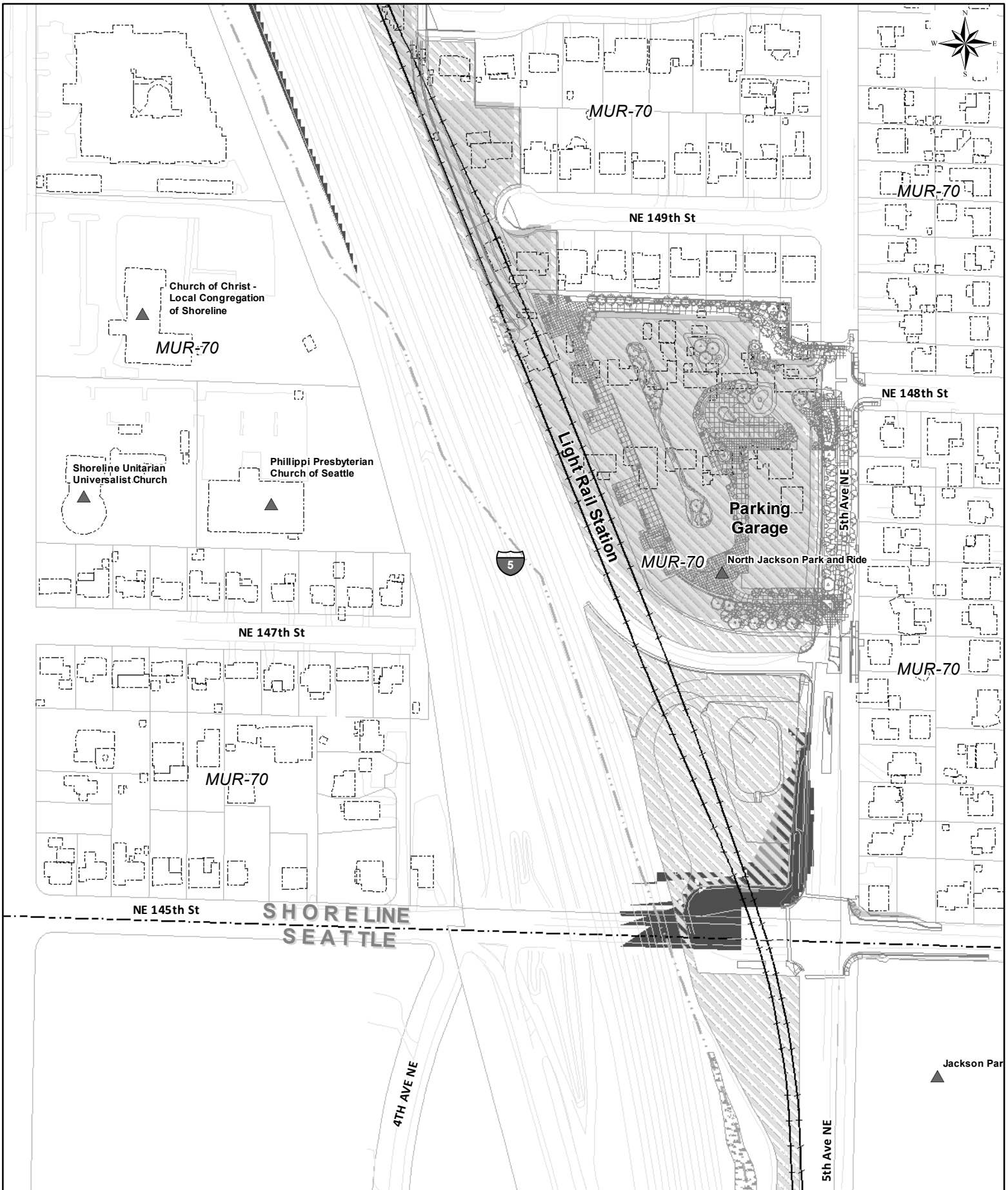

**Site Plan A - Shoreline South/145th Station and Parking Garage**

- ▲ Points of Interest
- Proposed Project
- Light Rail
- Existing Roads
- Stream
- Wetland
- ▨ Waterbody
- ▨ Swale
- ▨ City Boundaries
- ▭ Existing Buildings
- ▭ Parcels
- ▭ Proposed Acquisitions

- R6 Zoning
- ▨ Construction Staging Areas
- ▨ Moderately High Landslide Hazard Areas
- ▨ Very High Landslide Hazard Areas

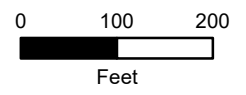

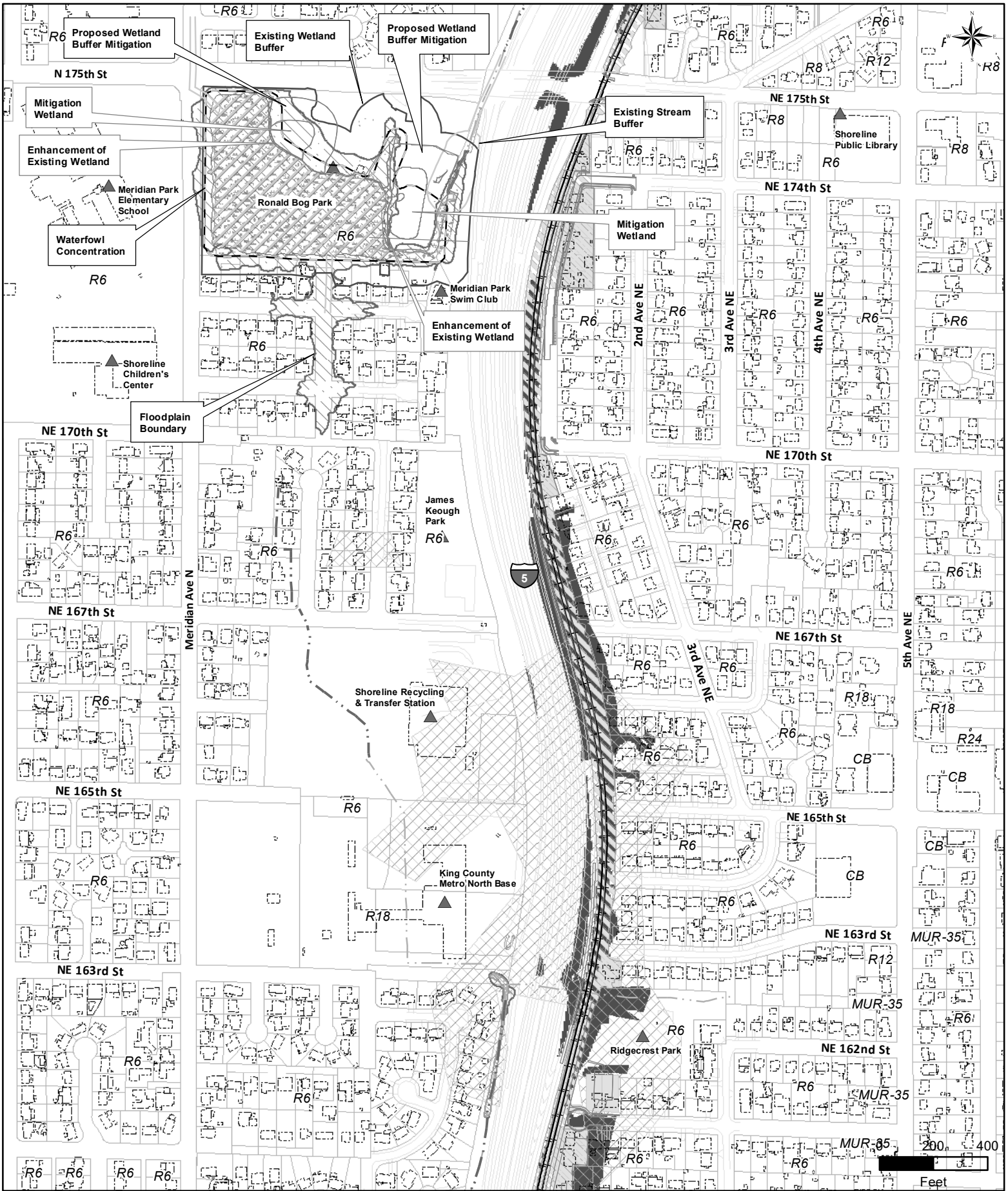

**Site Plan B - Ridgcrest Park and Ronald Bog Park**

- |                      |                         |                   |                                  |   |  |
|----------------------|-------------------------|-------------------|----------------------------------|---|--|
| ▲ Points of Interest | --- Stream              | ▨ Wetland         | ▭ Existing Buildings             | ▭ Priority Habitat and Species (PHS) Area | ▨ Moderately High Landslide Hazard Areas |
| — Light Rail         | --- Site Stream Line    | ▨ Waterbody       | ▭ Parcels                        | ▨ FEMA Designated Floodway                | ▨ Very High Landslide Hazard Areas       |
| — Proposed Project   | --- Site Stream Buffer  | ▨ Swale           | ▭ Proposed Acquisitions          | ▨ FEMA 100 Year Floodplain                | <b>R6</b> Zoning                         |
| — Existing Roads     | --- Site Wetland Buffer | ▭ City Boundaries | ▨ Potential Erosion Hazard Soils | ▨ Construction Staging Areas              |  |

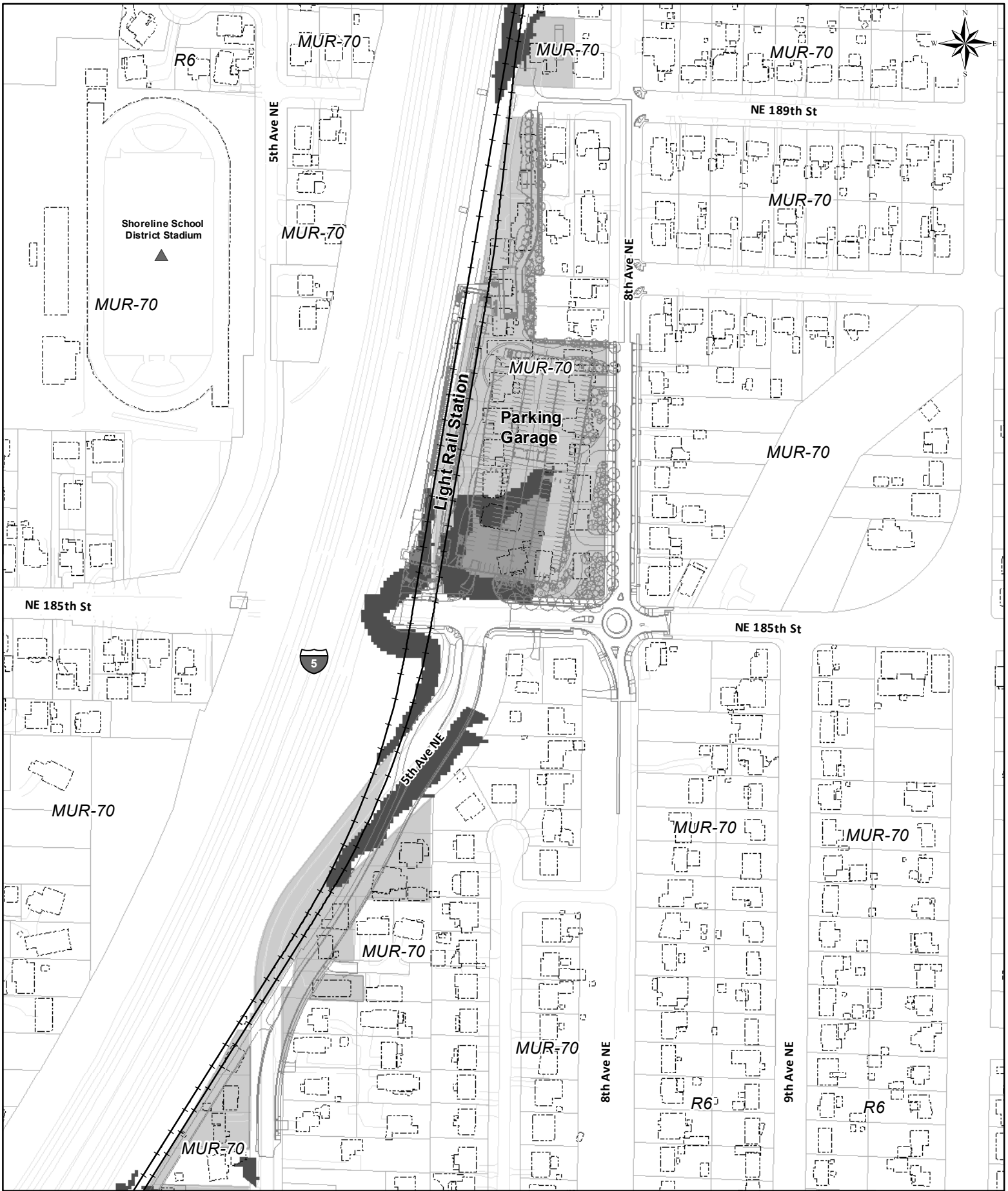

**Site Plan C - Shoreline North/185th Station and Parking Garage**

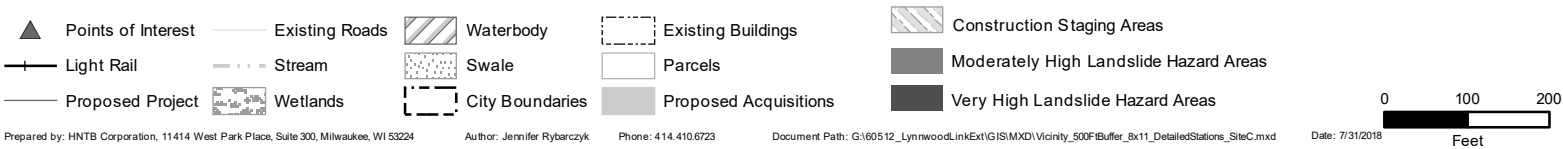

## City of Shoreline Revised Notice of Special Use Permit Application

*This project is being re-noticed to conform to SMC 20.30.060. The comment period has been revised. All comments received during the original comment period are still valid.*

**Location:** The new Lynnwood Link Extension Light Rail Transit Project facilities and systems are located within Shoreline on the east side of I-5, paralleling I-5, beginning from the southern City limits at NE 145<sup>th</sup> Street, extending northern to the north City limits by State Route 104/NE 205<sup>th</sup> Street. **Application No.:** SPL18-0140.

**Type of Permit(s) Required:** Critical Areas Special Use Permits, Street Vacation Petition(s), Floodplain Development Permits, Noise Variances, Lot Line Adjustment/Lot Merger Permits, Demolition Permits, Site Development Permits, Right-of-Way Use Permits, Building Permits, Miscellaneous Structure Permits, Mechanical Permits, Plumbing Permits, Wastewater Permits, Fire System Permits, and Sign Permits.

**Project Description:** Sound Transit has requested a special use permit to construct an approximately 3.2 mile segment of the Lynnwood Link Extension Light Rail Transit Project facilities and systems, including two stations, within the City of Shoreline.

The public comment period ends **October 24, 2018 at 5:00 p.m.** Please Public Comment: mail or deliver comments to City of Shoreline, Attn: Jennifer K. Wells, 17500 Midvale Avenue N, Shoreline, WA 98133; fax (206) 801-2788; or email to [jwells@shorelinewa.gov](mailto:jwells@shorelinewa.gov).

Copies of the full notice of application, application materials, and applicable codes are available for review at the City Hall, 17500 Midvale Avenue N.



17500 Midvale Avenue North  
Shoreline, WA 98133-4905  
(206) 801-2500

## DECLARATION OF MAILING

I, Bob Ryburn, Account Representative, Arctic Printing and Graphics, Inc., declare the following:

I am over the age of 18, a resident of Washington State and have no interest in the proposal described in the attached notice. I certify that I mailed a true and correct copy of the attached notice to recipients on the attached list, postage prepaid, on Wednesday, October 3, 2018.

  
Signature

Dated this 9 day of April, 2018 at Shoreline, Washington

Project #: PLN18-0140 (Re-notice of SUP application)

## Ann Migdal

---

**From:** bob.ryburn@arcticprinting.com  
**Sent:** Monday, October 8, 2018 8:52 AM  
**To:** Ann Migdal  
**Subject:** Re: [EXTERNAL] Fwd: Proof Attached: CoShoreline STLRP#3 Reprint - Job No. 55324

Yes, it was mailed on Wednesday October 3rd.

Bob

On 2018-10-08 09:46, Ann Migdal wrote:

> Hi Bob,  
>  
> I didn't see this come in last week.... Can you please confirm that the  
> mailing went out as planned on Wednesday, 10/3?  
>  
> Thank you.  
>  
> \_ANN MIGDAL\_  
>  
> \_Administrative Assistant II\_  
>  
> City of Shoreline  
>  
> 17500 Midvale Avenue N  
>  
> Shoreline, WA 98133-4905  
> amigdal@shorelinewa.gov  
>  
> P: (206) 801-2562 / F: (206) 801-2788  
>  
> www.shorelinewa.gov [2]  
>  
> FROM: Bob Ryburn [mailto:bob.ryburn@arcticprinting.com]  
> SENT: Wednesday, October 03, 2018 4:45 PM  
> TO: Ann Migdal <amigdal@shorelinewa.gov>  
> SUBJECT: Re: [EXTERNAL] Fwd: Proof Attached: CoShoreline STLRP#3  
> Reprint - Job No. 55324  
>  
> Will do.  
>  
> Bob  
>  
>> On Oct 3, 2018, at 2:40 PM, Ann Migdal <amigdal@shorelinewa.gov>  
>> wrote:  
>>  
>> Hi Bob,  
>>  
>> I've attached another Declaration of Mailing for the re-notice of the

>> SUP application. Once the notice is at the post office, can you  
>> please sign and PDF a copy of the Declaration back to me and mail the  
>> original to us at your convenience? Please include Juniper and  
>> Jennifer when you email us the PDF of the Declaration.

>>  
>> Many thanks!

>>  
>> \_ANN MIGDAL\_  
>>  
>> \_Administrative Assistant II\_  
>>  
>> City of Shoreline  
>>  
>> 17500 Midvale Avenue N  
>>  
>> Shoreline, WA 98133-4905  
>> amigdal@shorelinewa.gov  
>>  
>> P: (206) 801-2562 / F: (206) 801-2788  
>>  
>> www.shorelinewa.gov [1]

>>  
>> FROM: Ann Migdal  
>> SENT: Tuesday, October 02, 2018 3:24 PM  
>> TO: 'Bob Ryburn' <bob.ryburn@arcticprinting.com>  
>> CC: Jennifer Wells <jwells@shorelinewa.gov>; Juniper Nammi  
>> <jnammi@shorelinewa.gov>  
>> SUBJECT: RE: [EXTERNAL] Fwd: Proof Attached: CoShoreline STLRP#3  
>> Reprint - Job No. 55324

>>  
>> Hi Bob,  
>>  
>> Hope everything is on track for you for tomorrow's mailing.  
>>  
>> Accounting has already cut the check for the postage and it is  
>> sitting on my desk – you can pick it up at your convenience today or  
>> any time tomorrow.

>>  
>> Thanks!

>>  
>> \_ANN MIGDAL\_  
>>  
>> \_Administrative Assistant II\_  
>>  
>> City of Shoreline  
>>  
>> 17500 Midvale Avenue N  
>>  
>> Shoreline, WA 98133-4905  
>> amigdal@shorelinewa.gov  
>>  
>> P: (206) 801-2562 / F: (206) 801-2788

>>  
>> www.shorelinewa.gov [1]  
>>  
>> FROM: Bob Ryburn [mailto:bob.ryburn@arcticprinting.com]  
>> SENT: Thursday, September 27, 2018 12:11 PM  
>> TO: Ann Migdal <amigdal@shorelinewa.gov>  
>> CC: Jennifer Wells <jwells@shorelinewa.gov>; Juniper Nammi  
>> <jnammi@shorelinewa.gov>  
>> SUBJECT: Re: [EXTERNAL] Fwd: Proof Attached: CoShoreline STLRP#3  
>> Reprint - Job No. 55324  
>>  
>> Thanks Ann. I think we have it from here. Hope you enjoy your  
>> weekend.  
>>  
>> Bob  
>>  
>> On Sep 27, 2018, at 12:06 PM, Ann Migdal <amigdal@shorelinewa.gov>  
>> wrote:  
>>  
>> Hi Bob,  
>>  
>> Thanks for getting this to us. Yes, it looks fine and please proceed.  
>> And apologies for not responding more quickly – we were tied up in  
>> meetings this morning.  
>>  
>> Thanks again!!  
>>  
>> \_ANN MIGDAL\_  
>>  
>> \_Administrative Assistant II\_  
>>  
>> City of Shoreline  
>>  
>> 17500 Midvale Avenue N  
>>  
>> Shoreline, WA 98133-4905  
>> amigdal@shorelinewa.gov  
>>  
>> P: (206) 801-2562 / F: (206) 801-2788  
>>  
>> www.shorelinewa.gov [1]  
>>  
>> FROM: Bob Ryburn [mailto:bob.ryburn@arcticprinting.com]  
>> SENT: Thursday, September 27, 2018 9:08 AM  
>> TO: Ann Migdal <amigdal@shorelinewa.gov>  
>> CC: Juniper Nammi <jnammi@shorelinewa.gov>  
>> SUBJECT: [EXTERNAL] Fwd: Proof Attached: CoShoreline STLRP#3 Reprint  
>> - Job No. 55324  
>>  
>> Good Morning,  
>>  
>> Here's the updated letter. Look OK?



>>  
>> Bob  
>>  
>> 1-324-967-0700  
>>  
>> Begin forwarded message:  
>>  
>> FROM: Arctic Pre-Press <prepress@arcticprinting.com>  
>>  
>> SUBJECT: PROOF ATTACHED: COSHORELINE STLRP#3 REPRINT - JOB NO. 55324  
>>  
>>  
>> DATE: September 27, 2018 at 9:07:09 AM PDT  
>>  
>> TO: Bob Ryburn <bob.ryburn@arcticprinting.com>  
>>  
>> Bob:  
>>  
>> A PDF proof is attached below for the City of Shoreline's Sound  
>> Transit Light Rail Permit Notice #3 (Reprint). Job Number 55324.  
>>  
>> Please reply with approval or changes (if needed).  
>>  
>> Thanks,  
>>  
>> Kevin Bosley  
>>  
>> ARCTIC PRINTING PRE-PRESS DEPARTMENT  
>>  
>> prepress@arcticprinting.com  
>  
>  
>  
> Links:  
> -----  
> [1] <http://www.shorelinewa.gov/>  
> [2] <http://www.shorelinewa.gov>

# SHORELINE

## Geographic Information System LLE Noticing Area

### Legend

- LLE-Project Area\_6-2018
- LLE-Shoreline Optional Staging
- LLE SUP Notice Area
- City Boundary

### Road

- <all other values>

### STREETCLASS

- Interstate
- Collector Arterial
- Local Street
- Minor Arterial
- Neighborhood Collector
- Principal Arterial

- Ballinger
- Briarcrest
- Crista Ministries
- Echo Lake
- Fircrest
- Highland Terrace
- Hillwood
- Innis Arden
- Meridian Park
- North City
- Parkwood
- Richmond Beach
- Richmond Highlands
- Ridgecrest
- Seattle Golf Club
- Shoreline Community College
- The Highlands
- Westminster Triangle

- Tax Parcel
- Water
- Park or Trail



1 inch = 1,667 feet

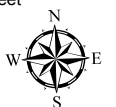

City of Shoreline  
17500 Midvale Ave N  
Shoreline, WA 98133  
(206) 801-2700  
[www.shorelinewa.gov](http://www.shorelinewa.gov)

Date: 4/16/2018



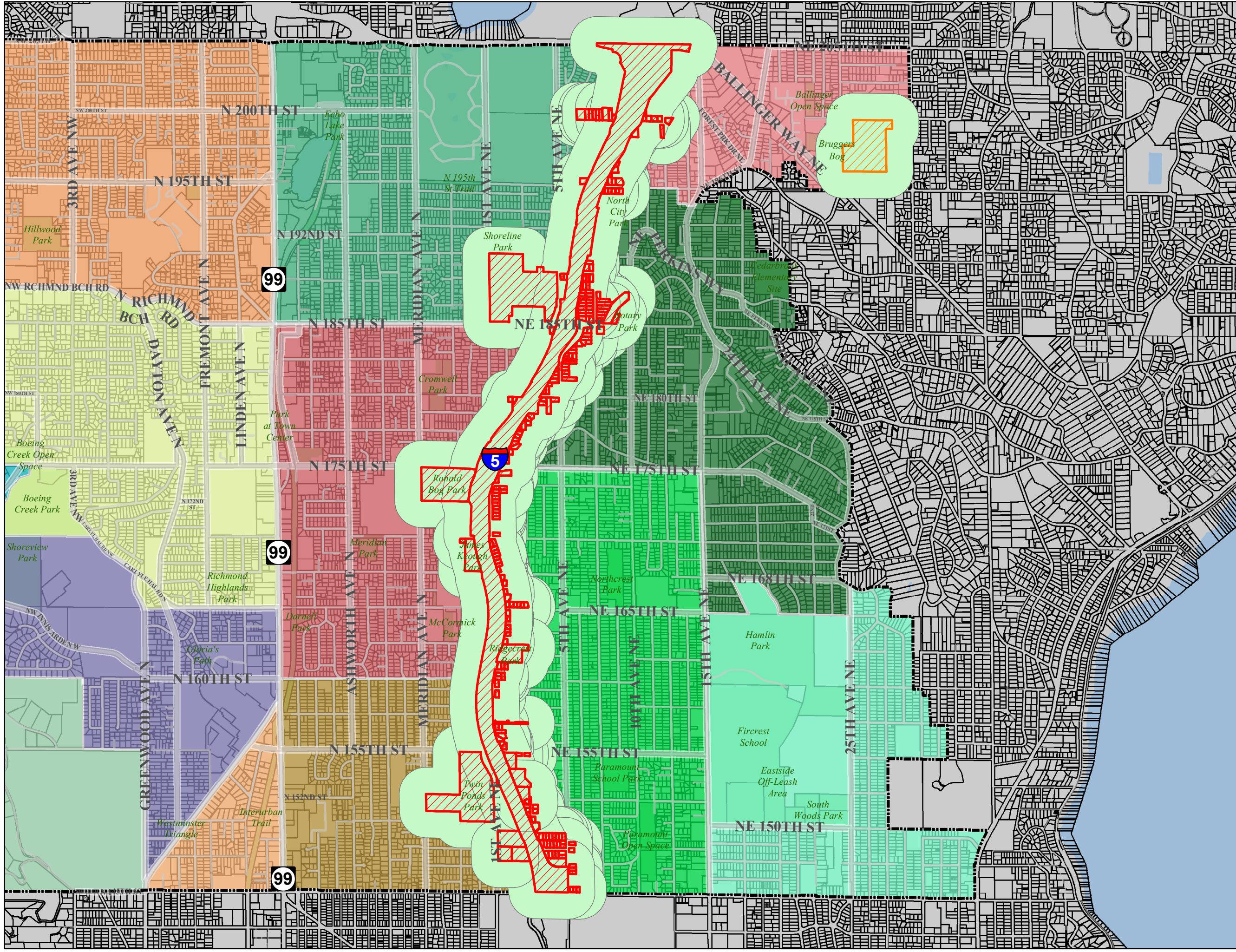









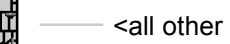



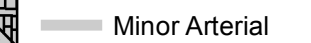

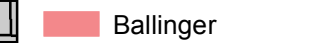
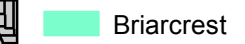

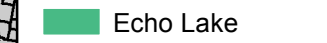

No warranties of any sort, including accuracy, fitness, or merchantability, accompany this product.

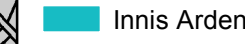
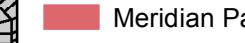
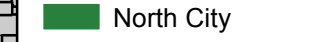

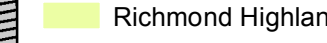
# SHORELINE

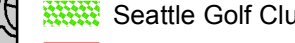
Geographic Information System

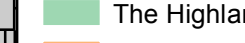
## LLE Noticing Area and Sign Locations Legend

-  LLE Project Area
-  City Boundary
- Road**
-  <all other values>
- STREETCLASS**
-  Interstate
-  Collector Arterial
-  Local Street
-  Minor Arterial
-  Neighborhood Collector
-  Principal Arterial
-  Ballinger
-  Briarcrest
-  Crista Ministries
-  Echo Lake
-  Fircrest
-  Highland Terrace
-  Hillwood
-  Innis Arden
-  Meridian Park
-  North City
-  Parkwood
-  Richmond Beach
-  Richmond Highlands
-  Ridgecrest
-  Seattle Golf Club
-  Shoreline Community College
-  The Highlands
-  Westminster Triangle
-  Tax Parcel
-  Water
-  Park or Trail

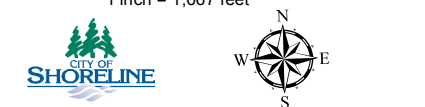
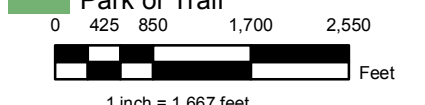

City of Shoreline  
 17500 Midvale Ave N  
 Shoreline, WA 98133  
 (206) 801-2700  
 www.shorelinewa.gov

Date: 4/16/2018  
 No warranties of any sort, including accuracy, fitness, or merchantability, accompany this product.

