

ATTACHMENT C: NEIGHBORHOOD MEETING SUMMARY



Lynnwood Link Extension

City of Shoreline

Special Use Permit: Neighborhood Meeting Summary

June 27, 2018

1. Purpose of Meeting

On June 27, 2018, Sound Transit held a Neighborhood Meeting from 6:00pm to 8:00pm at the Shorewood High School in the City of Shoreline. The purpose of the meeting was to discuss and obtain feedback from City residents and property owners on Sound Transit's plans for the Lynnwood Link Extension project in Shoreline. The Neighborhood Meeting met the City of Shoreline code requirements for:

- The Special Use Permit (SUP) for the project, and
- Alteration of geologic hazard areas classified as Very High Risk Landslide Hazard Areas

The meeting provided a forum for Sound Transit to present the project, have the community review the project proposal, and provide Sound Transit with feedback to be considered before a special use permit application and critical areas alteration permit applications are submitted to the City of Shoreline.

2. Meeting Notice

Meeting notices (see SUP Attachment D) were sent to all property owners and residents within 500 feet of properties affected (temporarily or permanently) by the project. This included notices sent to owners or residents of: properties adjoining properties with affected very high risk landslide hazard areas; and properties within 200 feet of the project clearing limits where a hazard area, or standard 50-foot buffer from the hazard area, overlaid the properties.

The meeting notice was postmarked to recipient owners and residents on June 13, 2018. The mailing list included 3,281 total addressees, comprising: 2,798 Shoreline residents; 465 property owners located in other cities or states; representatives of the Ballinger, Echo Lake, Meridian Park, North City, Parkwood, and Ridgcrest Neighborhood Associations; and governmental representatives of the City of Shoreline and other agencies.

3. Attendance

According to the door count, there were a total of 275 attendees at the Neighborhood Meeting, which also served as a general open house for the Lynnwood Link Extension project. While not all attendees chose to formally record their presence at the meeting, 160 attendees did provide their names and

addresses on the meeting sign-in sheet (Attachment 1). Of those, 54 attendees signed up to receive project permit updates from the City of Shoreline.

Fifteen representatives from Sound Transit attended the neighborhood meeting, to provide information and answer questions about the Lynnwood Link project. There were also several tables of representatives from partner groups, including Sound Transit's Bus Rapid Transit project, Sound Transit/Seattle Department of Transportation bikes, City of Shoreline, Shoreline School District, Seattle Department of Transportation, King County Metro and Community Transit.

4. Information Presented

Sound Transit staff and consultants gave a presentation to introduce key Sound Transit staff, describe the status of the Lynnwood Link Extension project, and describe the design and function of key project elements in the City of Shoreline, including two proposed light rail stations and associated garages.

The presentation also described the project permits anticipated in the City of Shoreline and provided contact information for the City. Presenters further described the means of officially commenting in response to the meeting, and noted how public comments from the meeting would be used.

For more detail, see the presentation materials from the Neighborhood Meeting (Attachment 2).

5. Comments, Questions, and Responses

Public comments at the meeting were received and documented in two ways. Comment forms were available to capture written comments after residents reviewed the project materials and asked questions of staff. As recommended by city staff, attendees could also leave comments on notes at each information station. Nineteen comment forms were submitted (Attachment 3) and seventeen comments were left on Post It notes at information stations (Attachment 4). Below is a summary of verbal and written comments received, and Sound Transit's responses. When multiple comments expressed the same idea, those were combined and addressed in a single response.

- Three residents commented that the stations should have escalators. One commenter mentioned that eliminating down escalators does not comply with ADA requirements.

In designing stations for Link Light Rail, Sound Transit evaluates the needs of its users getting to and from the station platform in a safe and efficient manner. The 185th station has a relatively moderate rise over the platform of 20 feet, which is below the common heights of many stations throughout the U.S. that do not provide escalators. As a public agency seeking to balance providing a good user experience and responsibly spending public dollars, Sound Transit determined that an escalator was not necessary for the majority of users at this station. However, at the 185th station, 5 elevators are provided for riders who need assistance getting to their desired destination.

Sound Transit complies with all ADA requirements at all of its facilities. Elevators are provided at each station to accommodate for the needs of users who require assistance.

- One attendee encouraged Sound Transit to leave space at each platform end to accommodate potential future platform extensions.

Sound Transit designed the stations platforms to conform to industry standards which can accommodate a four-car train. Sound Transit is currently running 2-3 car trains in the system, but the Shoreline stations are being built to accommodate a 4-car train system, when the need to expand arises. As ridership continues to increase, Sound Transit can also respond to this demand by operating its trains at greater frequency.

- An attendee commented that the stations have insufficient restroom facilities.

The standard protocol for design of Sound Transit stations does not include restroom facilities. However, due to the high public demand for restrooms, Sound Transit added them at both 145th and 185th stations. These restrooms are designed to serve the average rate of customer usage at each station. Some wait time during busy times of the day was considered in determining the number of stalls at each restroom.

- One resident expressed interest in the wetland mitigation activity at Ronald Bog, and would like to be contacted or receive pertinent information if there are any roles for citizen involvement in that mitigation effort.

Within the mitigation site proper, which will be permanently fenced off to prevent public access, safety issues and contract terms will preclude opportunities for citizen involvement during either the construction/planting phase or the required monitoring period. All initial planting will be performed by a contractor who is responsible for those plantings for the first year plant establishment period. After the first year, Sound Transit begins a monitoring period which can last anywhere from 5 to 10 years. During the monitoring period, Sound Transit is responsible for ensuring that strict performance criteria are met at the mitigation site in accordance with local, state, and federal permits. Meeting these performance criteria requires adherence to protocols and procedures controlled by Sound Transit staff and its contractors. There could, however, potentially be opportunities for citizen involvement in other areas of Ronald Bog Park, outside of the fenced off mitigation site. If such opportunities are identified in the future by either Sound Transit or the City of Shoreline, they would be made public.

- One resident had concerns that the boarding platforms at the Shoreline North/185th Street station were redesigned to be narrower as part of a cost-saving initiative. They were concerned that this would limit the station's capacity to handle passenger crowds during peak commute hours (especially with some people bringing bicycles and large suitcases). They requested that Sound Transit prioritize station usability.

The sizes of the platforms at 185th station were not reduced. The configuration changed from a center-platform design to a side-platform design. The sizes of the platforms are designed to accommodate the current and future expected usage of the Light Rail Station, going both north and south.

- Three Shoreline residents asked Sound Transit to consider maintaining as many trees as possible to mitigate sightlines to construction, as well as environmental reasons.

Through the environmental review process, many mitigation actions were identified for the LLE project, and replacement of trees removed due the project is one of them. Sound Transit is complying with all regulations for tree replacement in the City of Shoreline and along the I-5 corridor in the WSDOT right of way. Sound Transit is also, for the first time, planting vegetation under its elevated guideway.

Sound Transit is in compliance with City of Shoreline code and is planting vegetation buffers around and the garage and incorporating a mix of landscaping throughout the station sites. A balance between vegetation and safety must also be factored into the design of the landscaping, to minimize the potential for hiding behind densely vegetated areas.

- Seven residents commented about the colors presented as part of the design. Some residents liked the color schemes presented, while others did not.

Color choice is very important to Sound Transit, as a way to help users navigate the station and get to their desired destination, as well as adding visual interest to the buildings. The colors were chosen to support an artistic theme of native vegetation, cedar and fir trees, and the surrounding native habitats of wetlands and the Puget Sound. Sound Transit worked to find a balance of colors that fit with an overall theme for the City and western Washington.

- Two attendees requested increased bus service to the light rail stations.

That is a great question to ask of our bus transit partners, King County Metro and Community Transit. Their staff were present at the Shoreline open house to answer questions. Additionally, their contact information is as follows, King County Metro:

<https://kingcounty.gov/depts/transportation/metro/travel-options/bus.aspx>; 206-553-3000.

Community Transit: <https://www.communitytransit.org/>; 425-353-7433.

- One attendee liked the new design of the garage at 145th St Station better than the last façade.

The design of the garage at 145th is continuing to evolve. Some people have expressed support for the old design and some have expressed interest in the new design. Sound Transit is working

to balance our use of public dollars with the application of a design theme throughout the station and between the stations, consistent with the vegetated characteristics of the Shoreline community and compatible with neighborhood character.

- One resident asked if there will be adequate room to stand on the platform under cover, and noted other stations are very uncomfortable if it's raining or windy.

The station canopies are designed to cover the majority of the platform length and provide shelter from the weather for those waiting for the train to arrive. The platforms are not fully enclosed.

- One attendee asked that Sound Transit consider pedestrians traveling to the stations.

Sound Transit is making a variety of improvements to the surrounding transportation infrastructure to help improve access to the stations via car, bus, walking, and bike. Sound Transit must balance its expenditure of public dollars and unfortunately cannot commit to providing sidewalks on many arterials. Sound Transit recommends talking with your city representative to express these thoughts and discover the city's plans for improved access:

<http://www.shorelinewa.gov/>; 206-801-2700.

- Six residents had concerns about additional traffic on City streets, or inefficiencies at drop off areas.

To build this project, Sound Transit analyzed the impacts to the community through the environmental review process. The Project is designed to comply with all traffic flow requirements and had to ensure the City, its project would not diminish the level of service designated for each street. Where level of service was found to be diminished, street improvements were designed, to accommodate the increased traffic volume and return the street to the required level of service.

- Four attendees asked Sound Transit to consider eliminating or reducing parking garages.

There are two types of stations built by Sound Transit, urban and suburban. Urban stations are located in densely populated areas and do not include parking. Suburban stations are located in suburban areas and include parking. Shoreline, being a suburban area, has stations with parking garages, and it is designed this way to ensure the stations are appropriately used by a large percentage of the community. Sound Transit designed its stations to also encourage other modes of transportation, such as bus, bike, and walking.

- One attendee expressed concern about insufficient parking.

Two 500-stall garages are being built in the City of Shoreline resulting in a net increase of approximately 430 parking stalls. The stations are also designed to accommodate and encourage other modes of transportation such as bus, bike, and walking.

- One attendee requested a rezone to increase ridership.

The City of Shoreline has rezoned part of the City to accommodate higher growth, around the stations. More information can be found on the city's website or by contacting city staff: <http://www.shorelinewa.gov/>; 206-801-2700

- One attendee requested that Sound Transit consider providing public access to space around a project drainage facility.

The site in question (near NE 155th and Interstate 5) is planned to be a stormwater detention facility, constructed, owned, and maintained by the Sound Transit. The purpose of this site is to properly manage stormwater runoff, consistent with state and local regulations. Due to safety concerns and operational and maintenance requirements, public access cannot be allowed on this site. Residents interested in learning more about public access to green spaces may contact a local city representative: <http://www.shorelinewa.gov/>; 206-801-2700.

- Four residents expressed the desire to add a stop light or roundabout at 8th Ave NE in the vicinity of 188th and 185th to reduce potential traffic impacts. One resident requested Sound Transit add a traffic light instead of a traffic circle at the 185th Station.

To build this project, Sound Transit analyzed the impacts to the community through the environmental review process and designed the project to comply with all local traffic flow requirements and had to assure the city its project would not diminish the level of service designated for each street. Where level of service was found to be diminished, street improvements were designed, to accommodate the increased traffic volume and return the street to the required level of service. It was determined that traffic improvements were needed at 185th and 8th and Sound Transit, in consultation with the City traffic engineer determined a round-about design would better address traffic impacts. It was determined that no improvements at 188th were needed due to impacts from this project.

6. Summary of Proposed Modifications/Concerns that Sound Transit is Addressing

Based on input received from the meeting and in compliance with the City's Guiding Principles and Code, Sound Transit has added additional art work and visual interest to the garages to be

compatible with neighborhood character while balancing the visual preference between those who prefer the garage screening versus those who do not. Sound Transit will ensure the vegetation surrounding the stations, garages, and rail alignment to include tall, dense trees, while balancing the safety needs of the public.

7. Summary of Proposed Modifications/Concerns that Sound Transit is Unable to Address

Sound Transit is not proposing to provide additional escalators to its stations. The heights riders must travel to get to their desired destination is moderate for transportation hubs and the current design provides efficient mobility for the majority of users. For those who need additional assistance to get to their desired destination, elevators are provided. The elevators are also designed to maximize public safety by being transparent, both in and out.

Additional bathrooms will not be provided; the station bathrooms are designed to accommodate the average number of users expected throughout the day, which includes some wait-time during busy times of the day.

Sound Transit is not proposing to change the colors to its stations. Some comments express support for the chosen colors while some express discontent.

Sound Transit is not proposing to add additional street improvements beyond what was identified in environmental review documents and the design drawings.

Attachment 1: Neighborhood Meeting Sign-In



Lynnwood Link Extension Project Open House

Date: Shoreline 27th June
2018

Welcome to the open house! Please sign in below.

Name (first and last)	Mailing address (street address, city, zip code)	Email address	Yes, sign me up for Sound Transit email updates	Yes, sign me up for City of Shoreline permit updates by mail
Gary Molich Sok-Lan	17017 5 th Ave NE 18337 3 rd AVE NE	garymolich@comcast.net katwong2009@gmail.com	<input checked="" type="checkbox"/>	<input checked="" type="checkbox"/>
MICHAEL W. ERSMER	347 NE 154 th	mikeandjody75@gmail.com	<input checked="" type="checkbox"/>	<input checked="" type="checkbox"/>
Martin S. Bellman	17725 Hell Road Apt 303	ektenos@gmail.com	<input checked="" type="checkbox"/>	<input checked="" type="checkbox"/>
Tom Mailhot	2432 NW 20 th Place	tmailhot5@gmail.com	<input type="checkbox"/>	<input type="checkbox"/>
Dormad Head			<input type="checkbox"/>	<input type="checkbox"/>
Don Heath		heathlandscapes@yahoo.com	<input type="checkbox"/>	<input checked="" type="checkbox"/>
Stacey McCue	17733 2nd Pl NE Shoreline	pastcofam@comcast.net	<input checked="" type="checkbox"/>	<input checked="" type="checkbox"/>
Barbara Huel			<input type="checkbox"/>	<input type="checkbox"/>
Nancy Way	11015 1 st Ave NW, Seattle		<input type="checkbox"/>	<input type="checkbox"/>
Ginger Villanueva	15122 8 th Ave NE Shoreline		<input type="checkbox"/>	<input type="checkbox"/>
Susan L. Myers	4508-224 th Pl SW, Mtike Terrac, WA	powers.jacqueline@gmail.com	<input checked="" type="checkbox"/>	<input checked="" type="checkbox"/>
JACQUELINE POWERS	19107 15 th AVE NW SHORELINE		<input type="checkbox"/>	<input type="checkbox"/>
			<input type="checkbox"/>	<input type="checkbox"/>
			<input type="checkbox"/>	<input type="checkbox"/>

Sound Transit is a public agency and is subject to the State of Washington's Public Records act (RCW 42.17). Therefore, meeting sign-in sheets may be made available to anyone requesting them for noncommercial purposes. Meeting sign-in sheets should be turned into the Data Coordinator in the Communications Department.



Welcome to the open house! Please sign in below.

Name (first and last)	Mailing address (street address, city, zip code)	Email address	Yes, sign me up for Sound Transit email updates	Yes, sign me up for City of Shoreline permit updates by mail
Susana Guzman			<input type="checkbox"/>	<input type="checkbox"/>
Krista Tenney		tenney@earthlink.net	<input checked="" type="checkbox"/>	<input checked="" type="checkbox"/>
Scott Anderson	725 NE 201st St 98155	scottBA@msn.com	<input checked="" type="checkbox"/>	<input checked="" type="checkbox"/>
Marla Tullio	18538 Ashworth Ave. N Shoreline 98133	otterladi5@gmail.com	<input checked="" type="checkbox"/>	<input type="checkbox"/>
GENA MARGASON	15711 5 TH AVE N.E. SHORELINE, WA 98155		<input type="checkbox"/>	<input type="checkbox"/>
			<input type="checkbox"/>	<input type="checkbox"/>
			<input type="checkbox"/>	<input type="checkbox"/>
			<input type="checkbox"/>	<input type="checkbox"/>
			<input type="checkbox"/>	<input type="checkbox"/>
			<input type="checkbox"/>	<input type="checkbox"/>
			<input type="checkbox"/>	<input type="checkbox"/>
			<input type="checkbox"/>	<input type="checkbox"/>
			<input type="checkbox"/>	<input type="checkbox"/>
			<input type="checkbox"/>	<input type="checkbox"/>
			<input type="checkbox"/>	<input type="checkbox"/>
			<input type="checkbox"/>	<input type="checkbox"/>

Sound Transit is a public agency and is subject to the State of Washington's Public Records act (RCW 42.17). Therefore, meeting sign-in sheets may be made available to anyone requesting them for noncommercial purposes. Meeting sign-in sheets should be turned into the Data Coordinator in the Communications Department.



Lynnwood Link Extension Project Open House

Date: 6/27/18 Shoreline Open House

Welcome to the open house! Please sign in below.

Name (first and last)	Mailing address (street address, city, zip code)	Email address	Yes, sign me up for Sound Transit email updates	Yes, sign me up for City of Shoreline permit updates by mail
Paul Vanderzee	2218 N. 184th St Shoreline WA 98133	pbvanderzee@gmail.com	<input type="checkbox"/>	<input type="checkbox"/>
Andrew Sang	6548 39th Ave NE Seattle WA 98115	andrew.sang.seattle@gmail.com	<input checked="" type="checkbox"/>	<input checked="" type="checkbox"/>
Hope Morgan	18528-8 Ave NE Shoreline 98155		<input type="checkbox"/>	<input type="checkbox"/>
Jon Lebo	14026 30th Ave NE Lake Forest Park 98155	Jon.lebo@mindspring.com	<input checked="" type="checkbox"/>	<input type="checkbox"/>
Forrest Baum	14029 2nd Ave NW Seattle, WA 98177	forrestbaum@gmail.com	<input type="checkbox"/>	<input checked="" type="checkbox"/>
Quiana Hermigan	15502 8th Ave NE Shoreline WA 98155	JASOANANDQUIANA@GMAIL.COM	<input checked="" type="checkbox"/>	<input type="checkbox"/>
Kay Wright	P.O. Box 33839 Seattle 98133	kwright@wolfenet.com	<input checked="" type="checkbox"/>	<input checked="" type="checkbox"/>
Eureka Richards	17617 Ashworth Ave N Shoreline 98133	nek08038248@yahoo.com	<input checked="" type="checkbox"/>	<input checked="" type="checkbox"/>
Margie & Scott Jensen	829 NE 188th St Shoreline 98155		<input type="checkbox"/>	<input type="checkbox"/>
Barbara Gutballe	17531 Ashworth Ave N Shoreline 98133	gutballe@msn.com	<input checked="" type="checkbox"/>	<input checked="" type="checkbox"/>
Bill Franklin	Interlake Ave, Shoreline	wvfranklin@yahoo.com	<input checked="" type="checkbox"/>	<input type="checkbox"/>
Roxanne Kerani	5605 240th		<input type="checkbox"/>	<input type="checkbox"/>
Amy Walgamott		wiggtemott@gmail.com	<input checked="" type="checkbox"/>	<input type="checkbox"/>
INGA SCHENKER	15577 8th Ave NE, Shoreline 98155	ingaschenker@hotmail.com	<input checked="" type="checkbox"/>	<input checked="" type="checkbox"/>
			<input type="checkbox"/>	<input type="checkbox"/>



Lynnwood Link Extension Project Open House

Date: June 27, 2018 Shoreline
open house

Welcome to the open house! Please sign in below.

Name (first and last)	Mailing address (street address, city, zip code)	Email address	Yes, sign me up for Sound Transit email updates	Yes, sign me up for City of Shoreline permit updates by mail
Riva Ziff	2009 N 164 Pl Shoreline 98133		<input type="checkbox"/>	<input type="checkbox"/>
Mindy Drew	823 NE 190th St Shoreline 98155		<input type="checkbox"/>	<input type="checkbox"/>
MARILYN DEAN	150 NE 165th St Shoreline 98155		<input type="checkbox"/>	<input type="checkbox"/>
Royce DEAN	150 NE 165th St Shoreline 98155		<input type="checkbox"/>	<input type="checkbox"/>
Greg McCaslin	14992 5th Ave NE Shoreline 98155	gmccaslin@gmail.com	<input checked="" type="checkbox"/>	<input type="checkbox"/>
STUART VINCENT	3454 22nd Ave W Seattle, WA 98199	stuvincen@gmail.com	<input checked="" type="checkbox"/>	<input type="checkbox"/>
Sandy Nisperos	19500 Ballinger Way NE, #206 Shoreline WA 98155		<input checked="" type="checkbox"/>	<input checked="" type="checkbox"/>
Kevin/Anne Mukhar	17730 Corliss Ave N Shoreline WA 98133		<input type="checkbox"/>	<input type="checkbox"/>
Patty Hale	16528 8th Ave NE Shoreline 98155	Patricia-Hale-1@msn.com	<input checked="" type="checkbox"/>	<input checked="" type="checkbox"/>
Jan Lullness	PO Box 60273 Seattle 98160	frantl@wundermere.com	<input checked="" type="checkbox"/>	<input checked="" type="checkbox"/>
Dustin McIntyre	612 NE 170th St Shoreline, 98155		<input type="checkbox"/>	<input type="checkbox"/>
Christy Adams	18810 10th Ave NE, Shoreline 98155		<input type="checkbox"/>	<input type="checkbox"/>
David Ridley	18319 12th Ave NE	david.ridley@gmail.com	<input checked="" type="checkbox"/>	<input type="checkbox"/>
Alice Lawson	2536 NE 204th Shoreline 98155	lawsons01@comcast.net	<input checked="" type="checkbox"/>	<input type="checkbox"/>
Sharon Grader	10108-243rd Pl SW, Edmonds 98020		<input type="checkbox"/>	<input type="checkbox"/>



Lynnwood Link Extension Project Open House

Date: June 27, 2018
SHORELINE

Welcome to the open house! Please sign in below.

Name (first and last)	Mailing address (street address, city, zip code)	Email address	Yes, sign me up for Sound Transit email updates	Yes, sign me up for City of Shoreline permit updates by mail
Jalie Brown	18022 8th NE		<input type="checkbox"/>	<input type="checkbox"/>
Al Carr	18230 Olympic View DR, Edmonds 98020		<input type="checkbox"/>	<input type="checkbox"/>
Michael Ryhter	1311 N 175th St Shoreline wa 98133	MKRyhter@hotmail.com	<input type="checkbox"/>	<input type="checkbox"/>
Hye "	"	"	<input type="checkbox"/>	<input type="checkbox"/>
Dordon Trauson	P.O. Box 2021 Lynnwood WA 98036		<input type="checkbox"/>	<input type="checkbox"/>
Traci Barnes	20343 14th Ave NE #2 Shoreline 98133	Barnestm@aol.com	<input checked="" type="checkbox"/>	<input type="checkbox"/>
John & Sally Stevenson	14503 Meridian Ave N. Shoreline 98133		<input type="checkbox"/>	<input type="checkbox"/>
Francis Rust	2344 Edmunds Way E 101 Edmonds 98020	frust78290@gmail.com	<input checked="" type="checkbox"/>	<input type="checkbox"/>
Po and Yu Ling Lee	9948 SE 38th St. MERCER island. wa. 98040	206-229-1635	<input type="checkbox"/>	<input type="checkbox"/>
Sylvia Lee		leesylv@koreadailyseattle.com	<input type="checkbox"/>	<input type="checkbox"/>
Marilyn Lewis	307 N. E. 191st St. Shoreline		<input type="checkbox"/>	<input checked="" type="checkbox"/>
Karen Wasahi	17112 3rd Ave NE		<input type="checkbox"/>	<input type="checkbox"/>
Mary Anne Dechard	136 NE 166th St Shoreline		<input type="checkbox"/>	<input type="checkbox"/>
Lary Lowary	19817 Sunnyvale Drive N, T202		<input type="checkbox"/>	<input type="checkbox"/>
Chris Edwards	18553 8th Ave NE, Shoreline, WA 98155	edwardscd@comcast.net	<input type="checkbox"/>	<input type="checkbox"/>



Lynnwood Link Extension Project Open House
 Date: June 27 - Shoreline
 2018

Welcome to the open house! Please sign in below.

Name (first and last)	Mailing address (street address, city, zip code)	Email address	Yes, sign me up for Sound Transit email updates	Yes, sign me up for City of Shoreline permit updates by mail
Tim Molvik	17017 5th Ave 98155		<input type="checkbox"/>	<input type="checkbox"/>
Joyce Moldskred	401 NE 153rd street 98155		<input type="checkbox"/>	<input checked="" type="checkbox"/>
Anna Strahan	17059 2nd Ave NE 98155		<input type="checkbox"/>	<input checked="" type="checkbox"/>
Jean Tang	17562 12th Ave. NE 98155	jeantang567@gmail.com	<input checked="" type="checkbox"/>	<input checked="" type="checkbox"/>
David Anderson	1108 NE 200th 98155		<input type="checkbox"/>	<input type="checkbox"/>
Andrea Vederoff	18319 9th NE 98155		<input type="checkbox"/>	<input type="checkbox"/>
Marcia Porto	2332 N. 188 St 98133	marcialp70@outlook.com	<input checked="" type="checkbox"/>	<input type="checkbox"/>
Tom Spinney	7632 - 230th St. SW. Apt. B Edmonds, WA. 98026		<input type="checkbox"/>	<input checked="" type="checkbox"/>
Brian Stone	114 NE 167 St	SHORE WA 98155	<input checked="" type="checkbox"/>	<input type="checkbox"/>
Ellen Delos Santos	P.O. Box 55952 98155 19224 5th Ave NE Shoreline WA	Keikinnani @ MSN .COM	<input checked="" type="checkbox"/>	<input checked="" type="checkbox"/>
Anil Sood	13812 - SE 51st Pl, Bellevue	anilksood@gmail.com	<input checked="" type="checkbox"/>	<input checked="" type="checkbox"/>
Yoshiko Sasaki	Shoreline	on file	<input type="checkbox"/>	<input type="checkbox"/>
Linda Delgado	1810 N. 180th St. Shoreline 98133	lindadelgado23@gmail.com	<input checked="" type="checkbox"/>	<input type="checkbox"/>
DANAR HOVERSON	404 NE 153rd St. Shoreline 98155	danarhoverson@gmail.com	<input checked="" type="checkbox"/>	<input checked="" type="checkbox"/>
Mary Anne Thomason	15531 4th AVE NE, Shoreline, WA 98155	maryanne.thomason@gmail.com	<input checked="" type="checkbox"/>	<input type="checkbox"/>



Welcome to the open house! Please sign in below.

Name (first and last)	Mailing address (street address, city, zip code)	Email address	Yes, sign me up for Sound Transit email updates	Yes, sign me up for City of Shoreline permit updates by mail
Diane Hettrick		dhettrick@earthlink.net	<input type="checkbox"/>	<input checked="" type="checkbox"/>
DAVID LING		ZYLING53@yahoo.com	<input checked="" type="checkbox"/>	<input type="checkbox"/>
ERIC JONSSON		eric.jonsson@swedish.org	<input type="checkbox"/>	<input type="checkbox"/>
JOHN + JOSIE MEARNS		CYCLE 107@comcast.net	<input checked="" type="checkbox"/>	<input checked="" type="checkbox"/>
MICHAEL SHIOTA		michaelshiota@yahoo.com	<input type="checkbox"/>	<input checked="" type="checkbox"/>
PATRICK CARPELLETTI		PATRICK 4034@COMCAST.NET	<input type="checkbox"/>	<input checked="" type="checkbox"/>
Charles H Tupper		ct@chartupper.com	<input type="checkbox"/>	<input type="checkbox"/>
Georgia Selfridge		georgia@windermere.com	<input checked="" type="checkbox"/>	<input type="checkbox"/>
Kathryn Egan		Kathryn.egan@gmail.com	<input type="checkbox"/>	<input checked="" type="checkbox"/>
Caryl Lane		cjl4roma@gmail.com	<input checked="" type="checkbox"/>	<input checked="" type="checkbox"/>
John Regis		John regis a hot mail	<input checked="" type="checkbox"/>	<input checked="" type="checkbox"/>
BRUCE MCFARLANE		B MCFARLANE 20@MSU.COM	<input checked="" type="checkbox"/>	<input type="checkbox"/>
Barb Biddle		bbiddle.55@live.com	<input checked="" type="checkbox"/>	<input type="checkbox"/>
Blanca Nordin		petien@comcast.net	<input checked="" type="checkbox"/>	<input type="checkbox"/>
Fran Walsh		LANANDJEAN@Frontier.com	<input checked="" type="checkbox"/>	<input type="checkbox"/>



Welcome to the open house! Please sign in below.

Name (first and last)	Mailing address (street address, city, zip code)	Email address	Yes, sign me up for Sound Transit email updates	Yes, sign me up for City of Shoreline permit updates by mail
Mike & Robin Pretz	14878 -6 th AVE. NE SHORELINE 98155	ROB_MIKE69@HOTMAIL.COM	<input checked="" type="checkbox"/>	<input checked="" type="checkbox"/>
Patricia Ellis	17023 2nd Ave. N.E. " "	veraellis1950@gmail.com	<input checked="" type="checkbox"/>	<input checked="" type="checkbox"/>
C.D. Atkinson	2148 N. 183rd. Pl. 98133	cdaboats@gmail.com	<input checked="" type="checkbox"/>	<input checked="" type="checkbox"/>
LIZ POITRAS	18911 5 th AVE NE 98155	lizpoitras@hotmail.com	<input type="checkbox"/>	<input type="checkbox"/>
Luis ABAD JR	327 NE 149 th St. Shoreline, WA 98155	LABAD327@AOL.COM	<input checked="" type="checkbox"/>	<input checked="" type="checkbox"/>
Diana Johnson	219 NE 185 th ST Shoreline 98155	djohnson@u.washington.edu	<input checked="" type="checkbox"/>	<input checked="" type="checkbox"/>
Steph Darp	15520 Wallingford Ave N Shoreline	-	<input type="checkbox"/>	<input type="checkbox"/>
G Auacker	202 N. 201st + 5 th Shoreline 98133		<input type="checkbox"/>	<input type="checkbox"/>
Eric Dale	18027 5 th Ave NE Shoreline 98155		<input type="checkbox"/>	<input type="checkbox"/>
Chelsea Shapiro	1200 200 th Ave Shoreline	chelsea.raintown@kw.com	<input checked="" type="checkbox"/>	<input checked="" type="checkbox"/>
Jerry Erickson	18011 10 th Ave NW Shoreline WA 98177		<input type="checkbox"/>	<input type="checkbox"/>
Elizabeth Pinnick	18715 1 st Ave. N.E. Shoreline 98155	EPinnick107@.COM.	<input checked="" type="checkbox"/>	<input type="checkbox"/>
Desiree Hajek	20832 2nd Ave W Edmonds WA 98026	desireehajek@gmail.com	<input type="checkbox"/>	<input type="checkbox"/>
Christopher Deits	3740 NE 193 rd St. Lake Forest Park WA 98155	cdeits@comcast.net	<input checked="" type="checkbox"/>	<input type="checkbox"/>
Don LaCourse	19519 30 Ave NE Shoreline 98155	DFL2SEA@HOTMAIL.COM	<input checked="" type="checkbox"/>	<input checked="" type="checkbox"/>



Lynnwood Link Extension Project Open House

Date: June 27, 2018 Shoreline
open house

Welcome to the open house! Please sign in below.

Name (first and last)	Mailing address (street address, city, zip code)	Email address	Yes, sign me up for Sound Transit email updates	Yes, sign me up for City of Shoreline permit updates by mail
JEAN MUIR	17001 10th Ave NW/Shoreline 98177	Jeanmuir@ATT.NET	<input checked="" type="checkbox"/>	<input type="checkbox"/>
DAVID & JACKIE DUNLAP	5524 170th Pl. S.W. LYNNWOOD 98037	dkelunlap59@gmail.com	<input checked="" type="checkbox"/>	<input checked="" type="checkbox"/>
Sherry Wilson	20612 53rd Ave W Lynnwood 98036	slywilson@juno.com	<input checked="" type="checkbox"/>	<input type="checkbox"/>
Anil Sood	339 - NE 180th St, Shoreline	Adehisood@gmail.com	<input checked="" type="checkbox"/>	<input checked="" type="checkbox"/>
Tom Poitras	15911 5th Ave NE Shoreline		<input type="checkbox"/>	<input type="checkbox"/>
Michael Tosch	2135 N 154th St	mtosch@gmail.com	<input type="checkbox"/>	<input type="checkbox"/>
Rodrigo Pablico	16720 3rd Ave. NE, Shoreline, WA 98155	rpublico@comcast.net	<input checked="" type="checkbox"/>	<input checked="" type="checkbox"/>
Jo MOEN	11825 - 5th Ave NE 98155	jo.moen@comcast.net	<input checked="" type="checkbox"/>	<input type="checkbox"/>
Dennis & Gidget Terpstra	18815 Carliss Ave N 98133	dennis@terpstra.com	<input checked="" type="checkbox"/>	<input type="checkbox"/>
Erving Ashi	18354 Ashworth Ave N 98133	ashi98133@yahoo.com	<input checked="" type="checkbox"/>	<input checked="" type="checkbox"/>
Tony	624 Edmonds way 98020		<input checked="" type="checkbox"/>	<input type="checkbox"/>
Margaret Noyes	6618-146th St, SE Jackson WA 98224	mnoyes mrents4u@gmail.com	<input checked="" type="checkbox"/>	<input checked="" type="checkbox"/>
José G. Baquero	19715 N Park Ave N, Shoreline 98133	joscb1234@hotmail.com	<input checked="" type="checkbox"/>	<input checked="" type="checkbox"/>
Michelle Kelly	18308 3rd Ave NE		<input type="checkbox"/>	<input type="checkbox"/>
Rebecca Miner	18321 Dayton Pl N Shoreline WA 98135	rebecca.minor@comcast.net	<input checked="" type="checkbox"/>	<input checked="" type="checkbox"/>

Sound Transit is a public agency and is subject to the State of Washington's Public Records act (RCW 42.17). Therefore, meeting sign-in sheets may be made available to anyone requesting them for noncommercial purposes. Meeting sign-in sheets should be turned into the Data Coordinator in the Communications Department.



Lynnwood Link Extension Project Open House

Date: June 27th, 2018 *shoreline open house*

Welcome to the open house! Please sign in below.

Name (first and last)	Mailing address (street address, city, zip code)	Email address	Yes, sign me up for Sound Transit email updates	Yes, sign me up for City of Shoreline permit updates by mail
Billy & Robyn Montgomery	19803 BIRCH WAY Lynnwood, 98036	rmont1025@frontier.com	<input checked="" type="checkbox"/>	<input type="checkbox"/>
BRENDAN BLAYLOCK	20333 15 AVE NE 9 SHORELINE 98155	bblaylk@yahoo.com	<input checked="" type="checkbox"/>	<input type="checkbox"/>
CHARLOTTE HAINES	836 N.E. 194TH SHORELINE 98155		<input type="checkbox"/>	<input type="checkbox"/>
RICHARD BANKSTADT	12433 DE 141 ST WAY KIRKLAND		<input type="checkbox"/>	<input type="checkbox"/>
EUGENIE MCPHAIL	16726 BUCKE AVE. N. 98133	ebumpmail@comcast.net	<input checked="" type="checkbox"/>	<input type="checkbox"/>
Zong Peng	20012 20 th AVE. N.W. 98177	zongpeng98@hotmail.com	<input checked="" type="checkbox"/>	<input type="checkbox"/>
Robert Grasmick	14550 6 th NE Shoreline	—	<input type="checkbox"/>	<input type="checkbox"/>
JUDITH POLONI	SHORELINE	—	<input type="checkbox"/>	<input type="checkbox"/>
Katherine McIntyre	612 NE 170th Shoreline	Katherine.kocwick@gmail.com	<input type="checkbox"/>	<input checked="" type="checkbox"/>
Kyle Phillips	14815 6th Ave NE Shoreline 98155	—	<input type="checkbox"/>	<input type="checkbox"/>
Sally A. Waller	518 N. 175 th St. 98133	SLLWLL@Comcast.net	<input checked="" type="checkbox"/>	<input checked="" type="checkbox"/>
Ken & Judy CALLAHAN	1234 NW 202 nd 98177	CALLAHANJS@COMCAST.NET	<input checked="" type="checkbox"/>	<input type="checkbox"/>
Jared & Shauna Greene	127 NE 165 th St 98155	jagreene@gmail.com	<input checked="" type="checkbox"/>	<input type="checkbox"/>
Trisha Carson	14357 Ashworth Ave N 98133	TED228@gmail.com	<input type="checkbox"/>	<input type="checkbox"/>
			<input type="checkbox"/>	<input type="checkbox"/>



Lynnwood Link Extension Project Open House

Date: June 21, 2018 *shoreline open house*

Welcome to the open house! Please sign in below.

Name (first and last)	Mailing address (street address, city, zip code)	Email address	Yes, sign me up for Sound Transit email updates	Yes, sign me up for City of Shoreline permit updates by mail
Amy Ng	2010 N. 164th Pl. Shoreline Wa. 98133		<input type="checkbox"/>	<input type="checkbox"/>
Christopher Johns	14509 8th Ave NE, Shoreline, WA 98155	plainensincoer@g.com	<input checked="" type="checkbox"/>	<input type="checkbox"/>
Angie Paul	14851-6th Ave NE, Shoreline WA 98155	_____	<input type="checkbox"/>	<input type="checkbox"/>
Lon Buck	"	_____	<input type="checkbox"/>	<input type="checkbox"/>
Gregory Flynn	322 NE 117th St Seattle WA 98125	gregorybflynn@soundtransit.com	<input checked="" type="checkbox"/>	<input type="checkbox"/>
Katreva Samaras	18916 10th Ave NE, Shoreline, 98155	mskatreva@gmail.com	<input checked="" type="checkbox"/>	<input type="checkbox"/>
Kira Royer	530 NE 175th St, Shoreline, WA 98155		<input type="checkbox"/>	<input type="checkbox"/>
Fraukein Aragon	1842 N 183rd St, Shoreline WA 98133		<input type="checkbox"/>	<input type="checkbox"/>
CLAY TURNBOUGH	17028 1st Ave NE S. 98155	_____	<input type="checkbox"/>	<input type="checkbox"/>
DAVID DAMIANI	104 NE 170th St, Shoreline, WA, 98155		<input type="checkbox"/>	<input type="checkbox"/>
Elizabeth AMurphy	2126 N 130th St Seattle, WA 98133	eaobrien1326@yahoo.com	<input checked="" type="checkbox"/>	<input type="checkbox"/>
CHERYL ENNOR	1333 N 152nd St SL 98133	cenna@hotmail.com	<input checked="" type="checkbox"/>	<input type="checkbox"/>
TRACY WILBUR	14816 9TH PL NE	tracywilbur@gmail.com	<input checked="" type="checkbox"/>	<input type="checkbox"/>
Gillis DLVA			<input type="checkbox"/>	<input type="checkbox"/>
Minsoo Doo	6735A Alvarado Ave NW Seattle. 98117	minsoodo@gmail.com	<input checked="" type="checkbox"/>	<input type="checkbox"/>



Lynnwood Link Extension Project Open House

Date: June 27 2018 *shoreline open house*

Welcome to the open house! Please sign in below.

Name (first and last)	Mailing address (street address, city, zip code)	Email address	Yes, sign me up for Sound Transit email updates	Yes, sign me up for City of Shoreline permit updates by mail
Megan Joplin	8025 240th ST SW Edmonds WA 98026	meganfotog@gmail.com	<input checked="" type="checkbox"/>	<input type="checkbox"/>
Cyathia Padilla	16541 5th AVE NE #5, Shoreline WA 98155		<input type="checkbox"/>	<input type="checkbox"/>
Ethan Bancroft	320 N 188th St, Shoreline WA 98133	ethanbancroft@gmail.com	<input type="checkbox"/>	<input type="checkbox"/>
Glorianne Knight	337 NE 180th St, Shoreline, 98155	glonitea@comcast.net	<input checked="" type="checkbox"/>	<input type="checkbox"/>
Will Carson	14357 Ashworth Ave N, Seattle WA 98133	Guarman@gmail.com	<input type="checkbox"/>	<input type="checkbox"/>
Alex Ho			<input type="checkbox"/>	<input type="checkbox"/>
Aram Han	122 N 188th St Shoreline WA 98133	helloaramhan@gmail.com	<input checked="" type="checkbox"/>	<input type="checkbox"/>
Robert Murphy	2126 N 130th St, Seattle, 98133	AMSCAMURPHY@gmail.com	<input type="checkbox"/>	<input type="checkbox"/>
Vickie Johnson	375 NE 163rd St Shoreline 98155	SOGOOD33@COMCAST.NET	<input checked="" type="checkbox"/>	<input type="checkbox"/>
			<input type="checkbox"/>	<input type="checkbox"/>
			<input type="checkbox"/>	<input type="checkbox"/>
			<input type="checkbox"/>	<input type="checkbox"/>
			<input type="checkbox"/>	<input type="checkbox"/>
			<input type="checkbox"/>	<input type="checkbox"/>
			<input type="checkbox"/>	<input type="checkbox"/>
			<input type="checkbox"/>	<input type="checkbox"/>

Attachment 2: Neighborhood Meeting Presentation Slides



***Lynnwood Link Extension
Shoreline & Seattle Open House***

Presentation Overview

- Introductions
- Project description and schedule
- Construction preview
- Station design & updates
- Permits
- Open house guide



Current Service and Approved Projects

Near term Link extensions:

- University of Washington – Northgate (2021)
- Northgate – Lynnwood (2024)
- Downtown Seattle – Overlake (2023)
- Angle Lake – Federal Way (2024)
- Tacoma Theater District – S 19th

Additional extensions shown were passed in Sound Transit 3.





Lynnwood Link Extension

- 8.5 mile extension - Northgate to Lynnwood City Center
- 4 stations:
 - Shoreline South/145th – elevated
 - Shoreline North/185th – at grade
 - Mountlake Terrace – elevated
 - Lynnwood City Center – elevated

Project Schedule



Construction Preview

Summer 2018:

- Selective demolition
- Fieldwork

Construction anticipated in early 2019

- Early 2019
 - Utility relocations
 - Clearing and grading
- Mid-2019:
 - Active construction begins

Service begins 2024



Shoreline South/145th

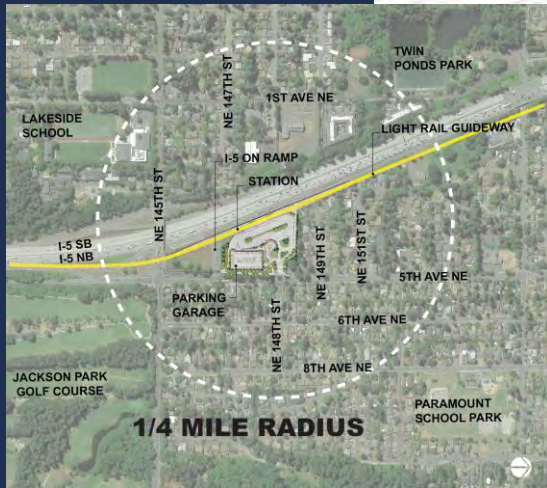

Vicinity Map and Site Plan

Shoreline South/145th



Aerial View

Shoreline South/145th

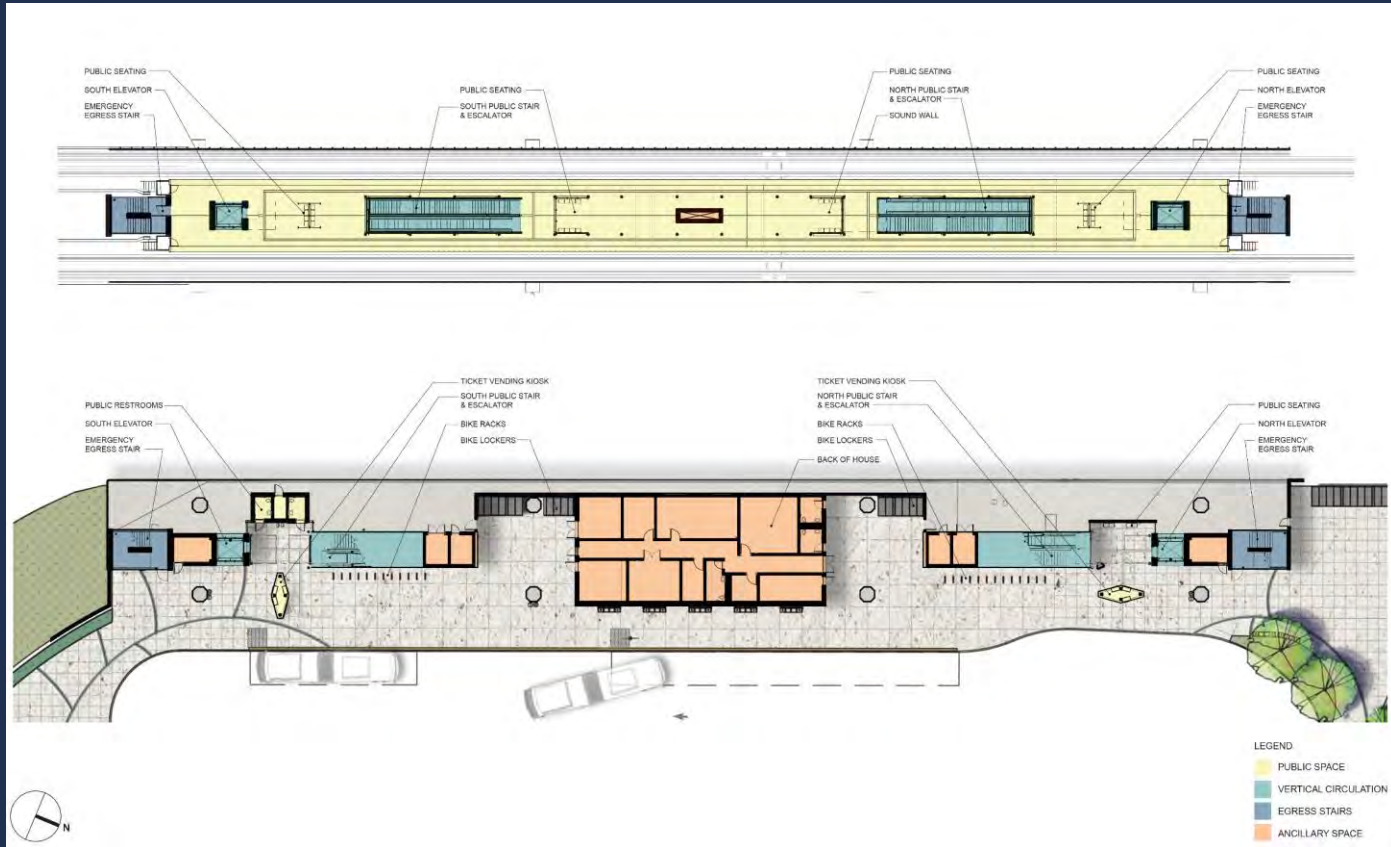

Floor Plan

Shoreline South/145th



View looking West from the South Pedestrian Plaza

Shoreline South/145th



North Entry View

Shoreline South/145th



South Entry View

Shoreline South/145th



Platform View

Shoreline South/145th



Parking garage

Station Artist: Buster Simpson

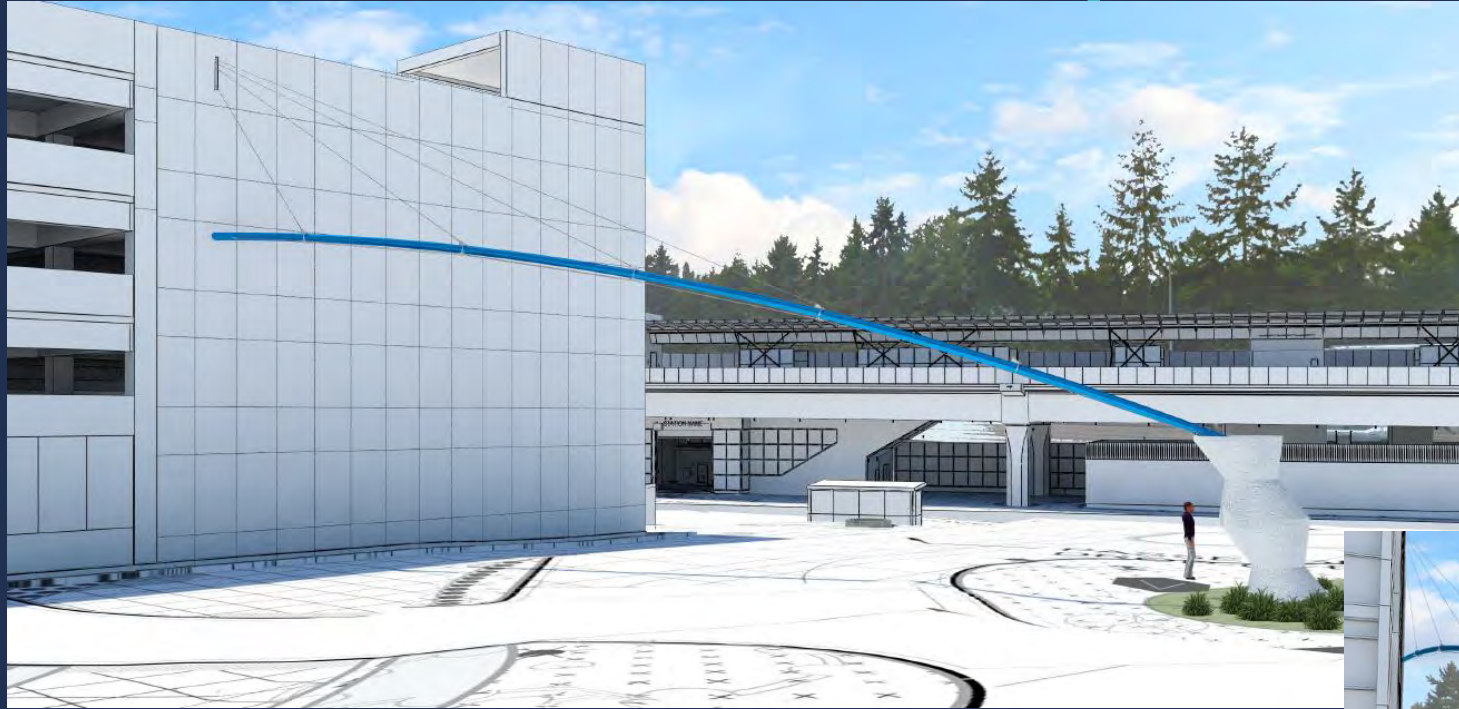

Shoreline North/185th



Vicinity Map and Site Plan

Shoreline North/185th



Aerial View

Shoreline North/185th

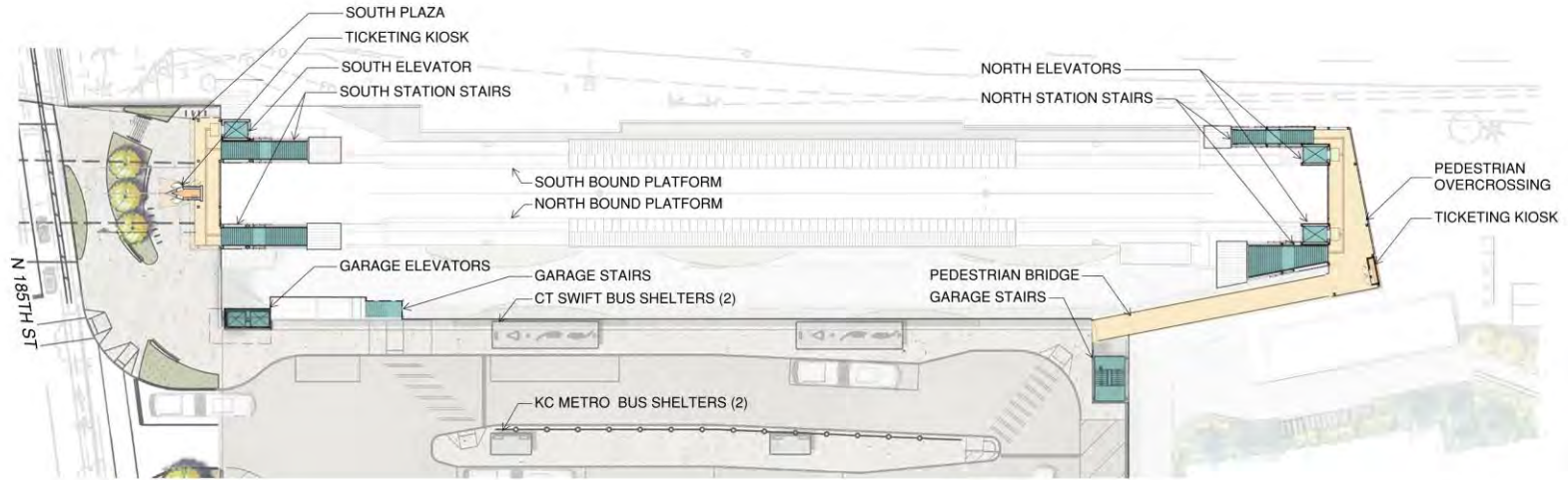

PLAZA LEVEL PLAN

Plaza Level Plan

Shoreline North/185th

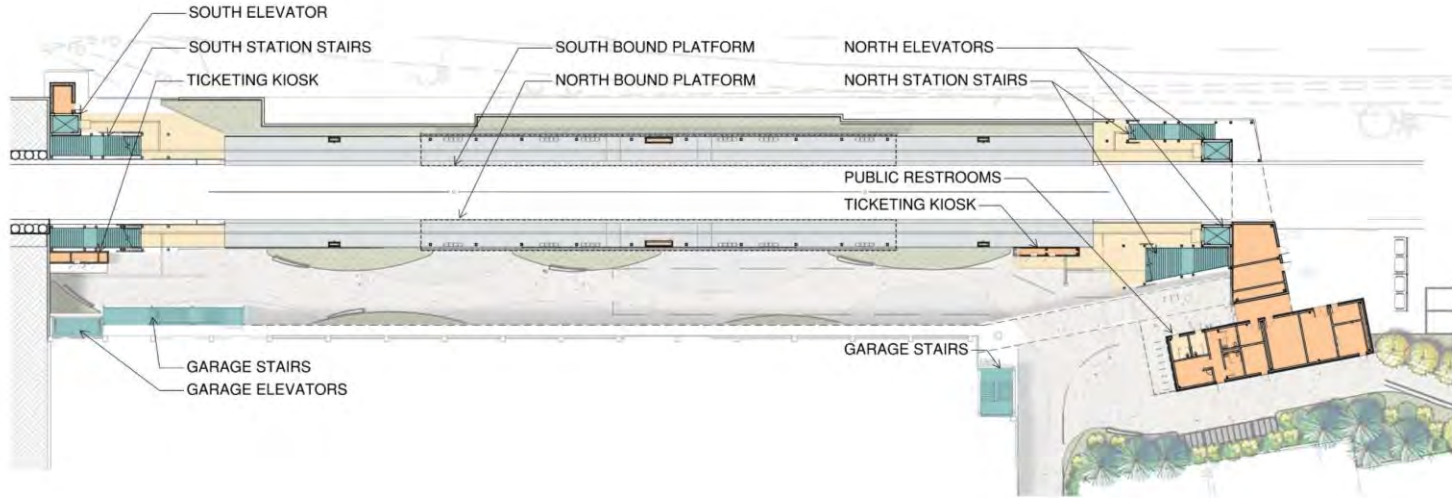

PLATFORM LEVEL PLAN

COLOR LEGEND

- TICKETING / BACK OF HOUSE SPACES
- PUBLIC SPACES
- VERTICAL CIRCULATION



Platform Level Plan

Shoreline North/185th



South Entry View

Shoreline North/185th



North Entry View

Shoreline North/185th



Pedestrian bridge

Shoreline North/185th



Platform View

Station Artist: Mary Lucking

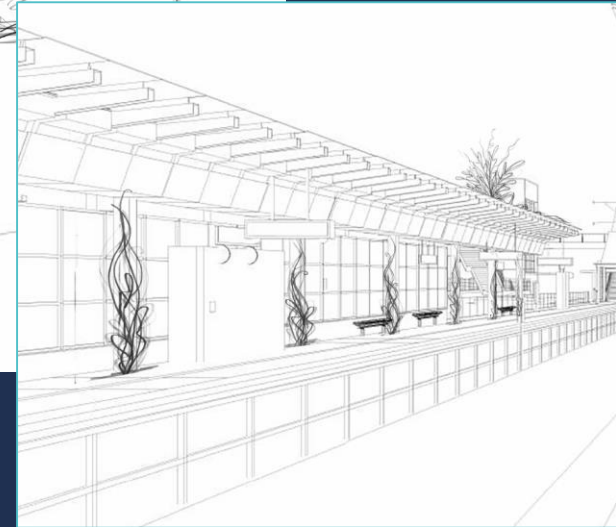

Also tonight: Part of City of Shoreline Special Use Permit application

Intent of Permit:

- Tonight's meeting satisfies requirement for application to City of Shoreline
- Permit will place conditions on project to ensure compatibility with adjacent land uses
- SUP addresses critical areas and administrative code modifications required for the project

Process:

- Formal application submittal August 2018
- 21-day Public Comment Period starts with City's Notice of Application
- Final decision is made by the City's Hearing Examiner

Critical areas

Wetlands, Streams, and Buffers

- Most wetlands between NE 151st St to NE 155th St
- Filling 0.35 ac of wetlands and 0.68 ac of buffers
 - Mitigating at Ronald Bog Park
- Vegetation impacts to McAleer Creek buffer to be restored on-site in I-5/SR 104 Interchange loop

Critical areas (continued)

Landslide Hazard Areas

- Very high-risk landslide areas as defined by City
 - North and south of Ridgcrest Park – NE 159th to NE 172nd
 - North of North City Elementary – NE 189th to NE 205th St
- Removing vegetation and excavating cut/fill slopes
- Design strategies include tiebacks and retaining walls

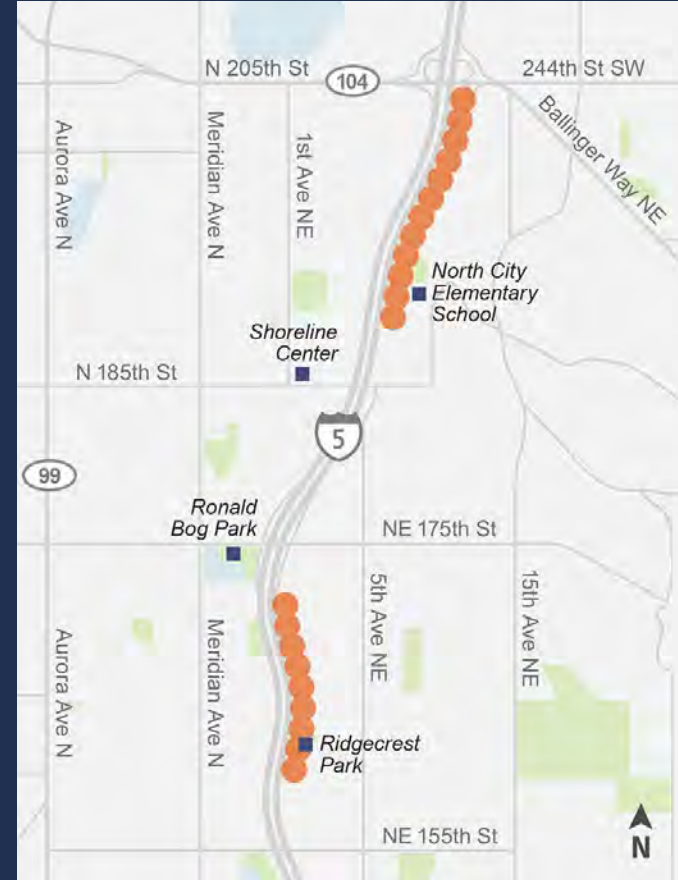

List of other anticipated permits

- Critical Area Special Use Permits for Ronald Bog Mitigation Site and McAleer Creek
- Building Permits
- Demolition Permits
- Site Development Permits
- Right-of-Way Use Permits
- Floodplain Development Permits

Comments and information

- Comment sheets and sticky notes
- Comments and Sound Transit's responses documented in a Neighborhood Meeting Summary
- Sign up to receive more information on the SUP
- Contact for City of Shoreline:

Jennifer Wells

City of Shoreline - ST Senior Planner

Phone: (206) 801-2528

Email: jwells@shorelinewa.gov

Open House guide



Lynnwood Open House: 7/25/2018
Lynnwood Convention Center

Online Open House:
[LynnwoodLink.Participate.Online](https://www.lynnwoodlink.com/participate/online)



Thanks!

soundtransit.org/LLE



Attachment 3: Public Comment Forms



Lynnwood Link Extension

Link light rail extensions

Share your comments!

Please provide your contact information and check the box below if you would like to receive project updates.

Name Bill Franklin Organization (optional)

Address Shoreline, WA

Email wvfranklin@yahoo Phone

Sign me up for Lynnwood Link Extension email updates.

The 185th street station must have escalators. I understand they were removed for cost-cutting, with premise being the grade-change is not quite as much as other stations, but forcing all users to take stairs UP from platform, even only 20 feet, is unrealistic. Elevators alone are not viable. Design platforms to have at least UP-only escalators. This will discourage so many people from using this station. Escalators are critical for viability.
thank you.

Stay informed about the Lynnwood Link Extension:

Visit our website: www.soundtransit.org/LLE

Sign up for project updates: www.soundtransit.org/subscribe

Email the project: LynnwoodLink@soundtransit.org

Have specific questions or a community group we should visit?

Call Sound Transit Community Outreach: 206-398-5300

Thank you for taking the time to comment!





Lynnwood Link Extension

Link light rail extensions

Share your comments!

Please provide your contact information and check the box below if you would like to receive project updates.

Name

Andrew Sang

Organization (optional)

~~Seattle~~

Address

Email

andrew.sang.seattle@gmail.com

Phone

Sign me up for Lynnwood Link Extension email updates.

I would like to encourage sound transit to ~~provide~~ leaving space at the ends of stations to accommodate potential future platform extensions. We have no idea what the future transit demand markets will look like. For example ULink hit us with an unexpectedly high ridership. What if it just so happens that when all the TOD in SnoCo/N King county gets built out, were unable to accommodate ridership? Perhaps it shall be necessary to do as the original Sound Move plan called for and run trains down 1-5, and if that happens, we'll need to have longer trains. Plus leaving these spaces is essentially free, since it doesn't need any new building. Just leaving 50-100' of space on each side for extensions will be sufficient. This will also allow ST to build out high quality ~~commuter~~ commuter rail to everett/sno, like the voters want

Thank you for taking the time to comment!

Stay informed about the Lynnwood Link Extension:

Visit our website: www.soundtransit.org/LLE

Sign up for project updates: www.soundtransit.org/subscribe

Email the project: LynnwoodLink@soundtransit.org

Have specific questions or a community group we should visit?

Call Sound Transit Community Outreach: 206-398-5300



Share your comments!

Please provide your contact information and check the box below if you would like to receive project updates.

Name _____ Organization (optional) _____

Address _____

Email _____ Phone _____

Sign me up for Lynnwood Link Extension email updates.

The 145th & 185th Stations plans have insufficient Restroom facilities, as evidenced by the current lack at the Northgate Transit Center.

Eliminating down escalators doesn't comply with ADA requirements.

Stay informed about the Lynnwood Link Extension:

- Visit our website: www.soundtransit.org/LLE
- Sign up for project updates: www.soundtransit.org/subscribe
- Email the project: LynnwoodLink@soundtransit.org
- Have specific questions or a community group we should visit?
- Call Sound Transit Community Outreach: 206-398-5300

Thank you for taking the time to comment!



Share your comments!

Please provide your contact information and check the box below if you would like to receive project updates.

Name **DAVID DAMMAN** Organization (optional)
Address **104 NE 170TH ST, SHORELINE, WA, 98155**
Email ~~damman@~~ Phone **206-930-6641**
 Sign me up for Lynnwood Link Extension email updates. **dammand99@gmail.com**

I am interested in the wetland mitigation activity @ Ronald Bay.
If you have any roles for citizen involvement in this, I would like to be contacted or receive my pertinent info.

Thank you.

Stay informed about the Lynnwood Link Extension:

Visit our website: www.soundtransit.org/LLE

Sign up for project updates: www.soundtransit.org/subscribe

Email the project: LynnwoodLink@soundtransit.org

Have specific questions or a community group we should visit?

Call Sound Transit Community Outreach: 206-398-5300

Thank you for taking the time to comment!



Lynnwood Link Extension

Link light rail extensions

Share your comments!

Please provide your contact information and check the box below if you would like to receive project updates.

Name Jean Muir + Jan Walcha Organization (optional) Residents

Address 17001 10th Ave NW / Shoreline, WA 98177

Email Jeanmuir@att.net Phone 206.546.9145

Sign me up for Lynnwood Link Extension email updates.

Thank you for the detailed presentation. We understood that as a cost saving measure it was decided to eliminate the down escalators at the 145th station. This is a concern because 3 flights of stairs are difficult if someone has any mobility issues / issues with sore / arthritic knees / balance issues. Elevators don't really solve the problem + at night pose security issues. We would appreciate consideration for adding at least 1 down escalator in addition to the up escalators.

Thank you for your consideration —

Stay informed about the Lynnwood Link Extension:

Visit our website: www.soundtransit.org/LLE

Sign up for project updates: www.soundtransit.org/subscribe

Email the project: LynnwoodLink@soundtransit.org

Have specific questions or a community group we should visit?

Call Sound Transit Community Outreach: 206-398-5300

Thank you for taking the time to comment!



Share your comments!

Please provide your contact information and check the box below if you would like to receive project updates.

Name Alex Ho Organization (optional)
 Address 1836 NW 202nd St / Shoreline WA 98177
 Email alexho223607@hotmail.com Phone 480-221-5774

Sign me up for Lynnwood Link Extension email updates.

It is my understanding that the boarding platforms at the Shoreline North / 185th St Link station were redesigned to be narrower as part of a package of design changes intended to address project cost overruns. I am concerned that this will limit the station's capacity to handle passenger crowds during peak commute hours (especially with some people bringing bicycles and large suitcases).

Please prioritize station usability as these design decisions are permanent once built and we have just one chance to get it right.

Thank you for your consideration and I look forward to riding the Lynnwood Link Extension when it opens in 2024.

Stay informed about the Lynnwood Link Extension:

Visit our website: www.soundtransit.org/LLE

Sign up for project updates: www.soundtransit.org/subscribe

Email the project: LynnwoodLink@soundtransit.org

Have specific questions or a community group we should visit?

Call Sound Transit Community Outreach: 206-398-5300

Thank you for taking the time to comment!

Share your comments!

Please provide your contact information and check the box below if you would like to receive project updates.

Name Anna Strahan Organization (optional)
 Address 17059 2nd Ave NE (please send updates).
 Email annastrahan@gmail.com Phone (206)852-8105
 Sign me up for Lynnwood Link Extension email updates.

As a longtime Shoreline resident (15 years) I have loved many things about the city and look forward to light rail making my commute to Seattle easier. Please consider the neighbors in the vicinity of acquired properties and make every effort to retain as many trees as possible (as a mitigation from seeing construction as well as environmentally a buffer for noise, dust, etc). We have a young child at home and I would very much appreciate a safe and tall buffer between our street and the construction zone. (≈ 174th & 2nd).
 Thank you!
 Anna

Stay informed about the Lynnwood Link Extension:

Visit our website: www.soundtransit.org/LLE

Sign up for project updates: www.soundtransit.org/subscribe

Email the project: LynnwoodLink@soundtransit.org

Have specific questions or a community group we should visit?

Call Sound Transit Community Outreach: 206-398-5300

Thank you for taking the time to comment!

Share your comments!

Please provide your contact information and check the box below if you would like to receive project updates.

Name Cynthia P. Organization (optional) _____

Address 16541 5th AVE NE, SHORELINE

Email _____ Phone _____

Sign me up for Lynnwood Link Extension email updates.

FUN COLORS

ART WORK IS ~~THE~~ MY FAVORITE PART

LOVE THE CONNECTION TO BUS RAPID TRANSIT.

Stay informed about the Lynnwood Link Extension:

Visit our website: www.soundtransit.org/LLE

Sign up for project updates: www.soundtransit.org/subscribe

Email the project: LynnwoodLink@soundtransit.org

Have specific questions or a community group we should visit?

Call Sound Transit Community Outreach: 206-398-5300

Thank you for taking the time to comment!



Share your comments!

Please provide your contact information and check the box below if you would like to receive project updates.

Name _____ Organization (optional) _____

Address _____

Email _____ Phone _____

Sign me up for Lynnwood Link Extension email updates.

COLOR!
 Less Grey more Color!
 Happy colors will mean less \$
 spent on Train Police. Better
 behavior of riders, less littering.
 Grey is not a happy color, tanpe is
 not a happy color.

Stay informed about the Lynnwood Link Extension:

Visit our website: www.soundtransit.org/LLE
 Sign up for project updates: www.soundtransit.org/subscribe
 Email the project: LynnwoodLink@soundtransit.org
 Have specific questions or a community group
 we should visit?
 Call Sound Transit Community Outreach: 206-398-5300

Thank you for taking the time to comment!





Lynnwood Link Extension

Link light rail extensions

Share your comments!

Please provide your contact information and check the box below if you would like to receive project updates.

Name David Ridley Organization (optional)
Address 18319 12th Ave NE, Shoreline, WA 98155
Email david.ridley@gmail.com Phone 808-342-8468

Sign me up for Lynnwood Link Extension email updates.

My comment is regarding the new 185th station design. I do like that the garage was moved to the east side of I-5 to be co-located with the station. However, the new parking garage design is so large and creates a huge open concrete area. I'm wondering if there could be more greenery or potential commercial space located on top of the garage. It is such a large area and by comparison to the surroundings seems out of place. The new zoning will allow up to 6 story structures I believe, maybe it doesn't need to be so low?

Stay informed about the Lynnwood Link Extension:

Visit our website: www.soundtransit.org/LLC

Sign up for project updates: www.soundtransit.org/subscribe

Email the project: LynnwoodLink@soundtransit.org

Have specific questions or a community group we should visit?

Call Sound Transit Community Outreach: 206-398-5300

Thank you for taking the time to comment!



Share your comments!

Please provide your contact information and check the box below if you would like to receive project updates.

Name Ginger Villanueva Organization (optional) _____

Address _____

Email _____ Phone _____

Sign me up for Lynnwood Link Extension email updates.

Please plant tall trees + thick trees to hide the 145th St parking garage from 5th Ave as much as possible.

Stay informed about the Lynnwood Link Extension:
Visit our website: www.soundtransit.org/LLE
Sign up for project updates: www.soundtransit.org/subscribe
Email the project: LynnwoodLink@soundtransit.org
Have specific questions or a community group we should visit?
Call Sound Transit Community Outreach: 206-398-5300

Thank you for taking the time to comment!

Share your comments!

Please provide your contact information and check the box below if you would like to receive project updates.

Name Lisa Allen Organization (optional) _____

Address 1001 NW 167th St

Email LCAUEN@aol.com Phone _____

Sign me up for Lynnwood Link Extension email updates.

Will there be buses from Shoreline Community College to either of the Light Rail Stations?

Stay informed about the Lynnwood Link Extension:

- Visit our website: www.soundtransit.org/LLE
- Sign up for project updates: www.soundtransit.org/subscribe
- Email the project: LynnwoodLink@soundtransit.org
- Have specific questions or a community group we should visit?
- Call Sound Transit Community Outreach: 206-398-5300

Thank you for taking the time to comment!

Share your comments!

Please provide your contact information and check the box below if you would like to receive project updates.

Name _____ Organization (optional) _____

Address Shouline _____

Email _____ Phone _____

Sign me up for Lynnwood Link Extension email updates.

Thanks for changing the design of the garage at 145th St Station. The last facade was really terrible

Stay informed about the Lynnwood Link Extension:
Visit our website: www.soundtransit.org/LLE
Sign up for project updates: www.soundtransit.org/subscribe
Email the project: LynnwoodLink@soundtransit.org
Have specific questions or a community group we should visit?
Call Sound Transit Community Outreach: 206-398-5300

Thank you for taking the time to comment!

Share your comments!

Please provide your contact information and check the box below if you would like to receive project updates.

Name _____ Organization (optional) _____

Address _____

Email _____ Phone _____

Sign me up for Lynnwood Link Extension email updates.

I love the finishes for the 185th station. Very contemporary + nice.

A little hard to tell from the pictures... is there adequate room to stand on the platform under cover?

The airport station is awful when it is rainy +/or rainy + windy.

Stay informed about the Lynnwood Link Extension:

- Visit our website: www.soundtransit.org/LLE
- Sign up for project updates: www.soundtransit.org/subscribe
- Email the project: LynnwoodLink@soundtransit.org
- Have specific questions or a community group we should visit?
- Call Sound Transit Community Outreach: 206-398-5300

Thank you for taking the time to comment!



Lynnwood Link Extension

Link light rail extensions

Share your comments!

Please provide your contact information and check the box below if you would like to receive project updates.

Name A concerned long time Organization (optional)

Address taxpayer & citizen - how knows

Email the Area... Phone

Sign me up for Lynnwood Link Extension email updates.

Please consider the following:

We have NO sidewalks going East & West on most streets from 105th to 145th. I would hope that you would be considering the "walkers" who hopefully would walk to the transit stations.

Visit our neighborhood & check out 5th Ave NE between 105th & 185th. This is now a 2 lane road with bike lanes and how much traffic will you be adding to this "side street?"

Concerning your "drop off lane" it's a great idea but you should visit a grade school and see how inefficient it is at peak time.

Stay informed about the Lynnwood Link Extension:

Visit our website: www.soundtransit.org/LLE

Sign up for project updates: www.soundtransit.org/subscribe

Email the project: LynnwoodLink@soundtransit.org

Have specific questions or a community group we should visit?

Call Sound Transit Community Outreach: 206-398-5300

Thank you for taking the time to comment!



Share your comments!

Please provide your contact information and check the box below if you would like to receive project updates.

Name Amy Walgamott Organization (optional)

Address 14802 5th Ave NE

Email wigglemott@gmail.com Phone

Sign me up for Lynnwood Link Extension email updates.

To cut cost, Remove the parking garage at 145th. The garage will overrun in no time each day and cause additional traffic. People will park in the neighborhood. Since this is supposed to be a hub station, increase bus traffic to neighborhood park and ride lots instead. Disperse the parking and encourage transit instead. The parking lot will be an "epic fail" and cause a lot of grief besides. Also, it's atrocious to those having to look at and listen to it. 5th Ave NE can't accommodate all the traffic either, so let's discourage driving to the station. It just creates a major traffic bubble in one small area.

Stay informed about the Lynnwood Link Extension:

Visit our website: www.soundtransit.org/LLE

Sign up for project updates: www.soundtransit.org/subscribe

Email the project: LynnwoodLink@soundtransit.org

Have specific questions or a community group we should visit?

Call Sound Transit Community Outreach: 206-398-5300

Thank you for taking the time to comment!

Share your comments!

Please provide your contact information and check the box below if you would like to receive project updates.

Name Edgar Sioson Organization (optional) _____
 Address 2335 N 189th St, Shoreline, WA 98133
 Email siosone@gmail.com Phone _____

Sign me up for Lynnwood Link Extension email updates.

The N. 185th bus area is all concrete, need planters/trees.

The 500 car parking is too many.

Any plans for circulators to encourage carless access to station?

Stay informed about the Lynnwood Link Extension:

Visit our website: www.soundtransit.org/LLE
 Sign up for project updates: www.soundtransit.org/subscribe
 Email the project: LynnwoodLink@soundtransit.org

Have specific questions or a community group we should visit?
 Call Sound Transit Community Outreach: 206-398-5300

Thank you for taking the time to comment!



Share your comments!

Please provide your contact information and check the box below if you would like to receive project updates.

Name Scott Anderson Organization (optional) _____

Address 725 NE 201st St

Email scottBA@msn.com Phone 206 365-2238

Sign me up for Lynnwood Link Extension email updates.

Please Please consider traffic lights instead of a traffic circle.

The Buses should have a light to turn in and out of station

Cars will get on and off of 5th OK, but traffic on 5th will be a mess for both the cars and the BUSES

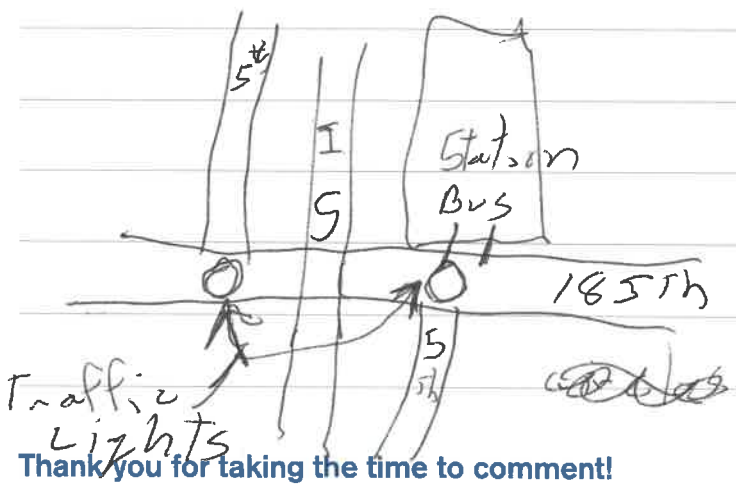

Stay informed about the Lynnwood Link Extension:

- Visit our website: www.soundtransit.org/LLE
- Sign up for project updates: www.soundtransit.org/subscribe
- Email the project: LynnwoodLink@soundtransit.org
- Have specific questions or a community group we should visit?
- Call Sound Transit Community Outreach: 206-398-5300

Share your comments!

Please provide your contact information and check the box below if you would like to receive project updates.

Name Molly Chapman Organization (optional) none

Address 18353 Ashworth Ave N.

Email _____ Phone _____

Sign me up for Lynnwood Link Extension email updates. already receive them.

Project looks really good. I like the changes made - the garage on the east side of 1-5 makes a lot more sense as a transit user. Glad the garage has been moved.

Thank you for presentation. Very informative and I look forward to the train service coming to Shoreline.

Stay informed about the Lynnwood Link Extension:

Visit our website: www.soundtransit.org/LLE

Sign up for project updates: www.soundtransit.org/subscribe

Email the project: LynnwoodLink@soundtransit.org

Have specific questions or a community group we should visit?

Call Sound Transit Community Outreach: 206-398-5300

Thank you for taking the time to comment!



M

Attachment 4: Summary of Public Comments on Post It Notes



Lynnwood Link Extension

Post-It Note Comments from June 27, 2018 Shoreline Open House

Type:	Location:	Transcribed Comment:
Post it	Shoreline South 145 th Station	<ol style="list-style-type: none"> 1. Cut cost by eliminating parking garage + have regional P+R instead 2. Concerned about neighborhood cut through traffic going to NE 148th to get direct access into station 3. Rezone! We're building this multi-billion dollar station with tax dollars. Why are we cutting our own ridership? 4. If ridership estimates are accurate, where will they all park? No parking on 155th & 5th. Don't say bus rapid ride. Zone permit.
Post it	NE 155 th street	<ol style="list-style-type: none"> 1. Strongly suggest this greenspace be given public access. Please email wvfranklin@yahoo.com
Post it	Shoreline South 145 th station (closer to 5 th ave NE)	<ol style="list-style-type: none"> 1. No support for garages. They bring in many cars which reduces livability. Have TOD instead to increase ridership.
Post it	185 th and 8 th	<ol style="list-style-type: none"> 1. Stop light please, or roundabout. Stop light at 185th and 8th.
Post it	Shoreline North & 185 th station	<ol style="list-style-type: none"> 1. 188th will be a main access for anyone coming from LFP and 15th ave "short cut".



Lynnwood Link Extension

Post-It Note Comments from June 27, 2018 Shoreline Open House

		<p>188th needs a stop light improvements.</p> <ol style="list-style-type: none"> 2. 188th street will be a main way people from 15th ave will reach the station. 3. The street improvement are not enough for the potential traffic on 188th st near 8th ave. 4. Stop light at 8th and 188th. 5. Stop light please or roundabout!
Post it	Material Board	<ol style="list-style-type: none"> 1. Orange is garish! Find a bright complementary color to keep theme of nature's understory! 2. The accent color for 145th station stands out without screaming at you. The neon orange color for 185th is TERRIBLE! It does not fit with our area! Please change it to something that adds color without being so in your face. 3. Agreed! Orange, yuk! 4. Orange really pops! It's great. Live a lil! 5. A nice cheerful color. Good for grey days. I like it.