

CITY OF SHORELINE CURRENTS

INSIDE • 2 Town Center • 3 Aurora • 4 Winter prep • 5 Healthy City • 6 Our Shoreline Photos • 7 Upcoming Events

Voters approved Shoreline Proposition 1 by 56%

In the November election, Shoreline voters passed Shoreline Proposition 1 to fund basic services including police, parks and community services. With a 72% voter turnout, Shoreline voters approved Proposition 1 by over 56%.

Proposition 1 asked voters to restore the City's regular property tax levy rate to \$1.48 per \$1,000 of assessed value, which remains under the \$1.60 legal limit.

"On behalf of the City Council, we are grateful for the support and trust of the Shoreline community," Shoreline Mayor Keith McGlashan stated. "The community's trust obligates us to continue to be good stewards of their tax dollars."

"Speaking for City staff, we appreciate the community's approval of Proposition 1. The community's support reinforces our commitment to increasing efficiencies and providing exceptional customer service," City Manager Robert Olander said.

The passage of Proposition 1 addresses the financial structural gap for 2011-2016, which was brought on

by the 1% limit to increase property tax revenues. Property tax revenue is the City's largest revenue source.

Council adopts 2011 Budget

On November 22 the City Council adopted the 2011 Budget. The budget consists of two major categories - \$36.2 million operations budget and \$33.7 million capital budget. The 2011 operations budget, net one-time accounting transfers, has decreased by 1% compared to the 2010 budget, while the City continues to experience increases in police and jail costs, health insurance premiums and state mandated retirement costs.

The cost to fund day-to-day City services, in inflation adjusted dollars, is approximately \$461 per resident, nearly 10% lower than in 2000. The City has had to do more with less given that inflation has grown 28% since 2000.

Although Proposition 1 addresses the City's structural revenue issues over the next six years, the City anticipates recessionary revenue declines for 2012 and 2013. While these projections are related to future budgets, the City Council believed it was prudent to capture savings in the 2011 budget to minimize the forecasted short-term gaps. As a result, the Council made additional line-item reductions and eliminated a vacant staff position for a total savings of approximately \$145,000.

For more information about Proposition 1 or the 2011 Budget, visit the Finance Department page on the City's website or contact Finance Director Debbie Tarry at (206) 801-2301 or dtarry@shorelinewa.gov.

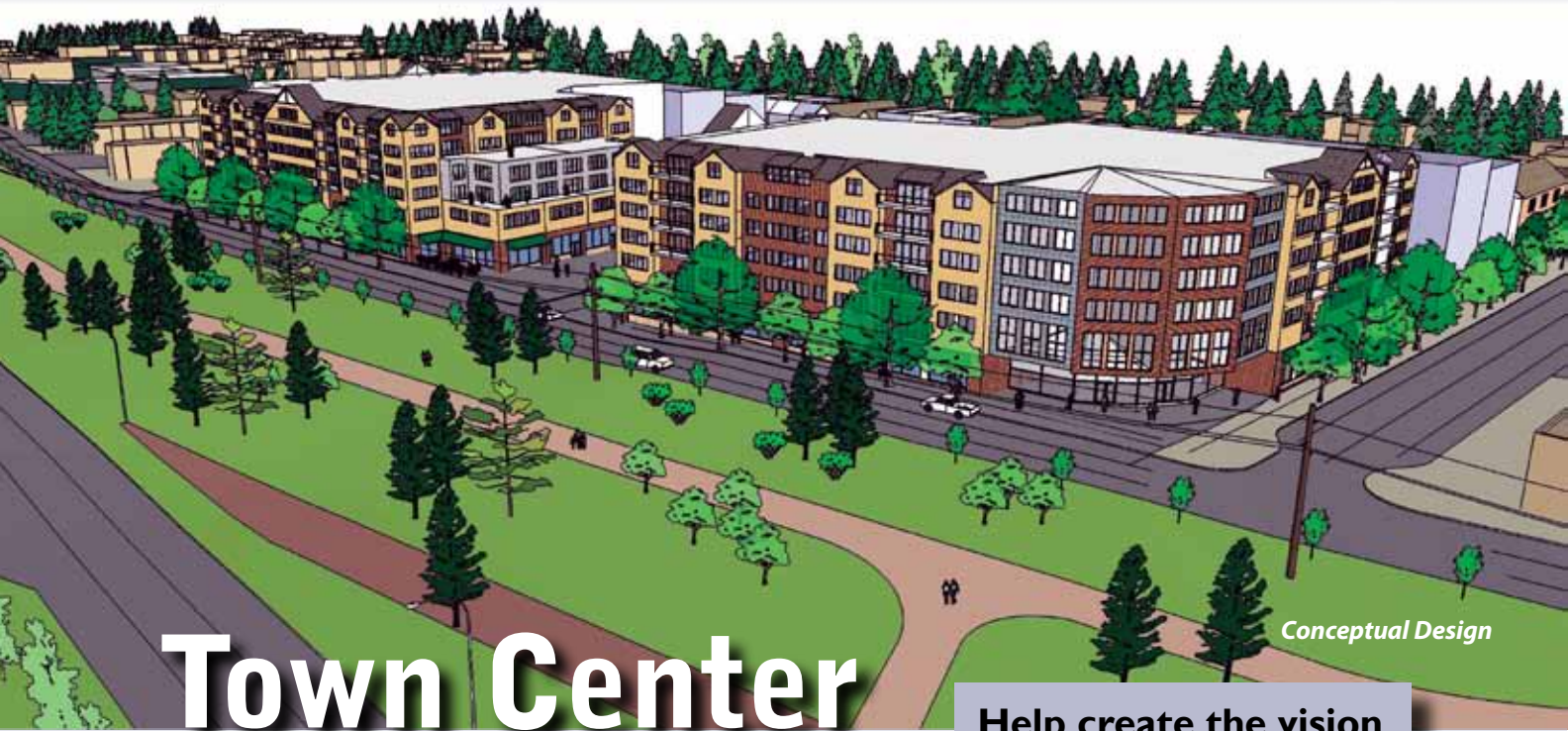

Conceptual Design

Town Center

January 12 Town Center Open House

Wednesday, Jan. 12, 6:30-9:00 p.m.
Shoreline City Hall, Council Chambers

After several years of community meetings, the proposed Town Center Subarea Plan and Town Center Zoning are ready for public review.

Join us at a Town Center Open House on Wednesday, Jan. 12, to learn about this important effort to guide future growth and development in the area along Aurora Avenue bound by N 170th Street, Stone Avenue, Linden Avenue and N 192nd Street.

For more information visit the Town Center Subarea Plan page under the projects tab at shorelinewa.gov/planning or call Project Manager Paul Cohen at (206) 801-2551.

Help create the vision for a Town Center park

Wednesday, Jan. 25, 6:30 p.m.
Shoreline City Hall
Council Chambers

Shoreline needs the community's help to create a vision for a new park being planned for the Town Center area.

The park will be located in the green space surrounding the Interurban Trail between NE 175th and NE 185th Streets.

It will become a key visual focal point for the future Town Center area. Imagine a public gathering space celebrating the City of Shoreline with unique lighting, abundant landscaping, casual seating, art and other amenities.

Now is the opportunity for the community to participate in creating the vision for that space, helping define Shoreline for years to come.

The first of three planning workshops is Tuesday, Jan. 25, at 6:30 p.m.

For more information visit the Town Center Subarea Plan page under the projects tab at shorelinewa.gov/planning or contact Project Manager Jon Jordan at (206) 801-2473 or jjordan@shorelinewa.gov.

Surface Water Utility open house

Wednesday, Jan. 19, 6:00-8:00 p.m.
Shoreline City Hall, Council Chambers

Managing Shoreline's extensive storm drainage system and numerous stormwater facilities and monitoring water quality in the streams, wetlands and lakes in Shoreline are all part of the mission of the City's Surface Water Utility.

The Utility needs the community's input as it updates the Surface Water Master Plan, which helps guide its activities over the next six years.

To share information about Surface Water services and hear from the community about its priorities and concerns, the Utility is hosting an open house on Wednesday, Jan. 19. For more information, visit the Surface Water link at shorelinewa.gov/publicworks.

AURORA CORRIDOR N 185th to N 192nd Streets

New construction begins soon on Aurora – again!

At its December 13 meeting, the Shoreline City Council awarded the construction contract for the N 185th Street to N 192nd Street segment of the Aurora Corridor Project to Johansen Excavating, based in Buckley, Washington.

The City's original construction cost estimate for this segment was \$9.1 million. Johansen Excavating submitted the winning bid of \$8.2 million.

The total estimated cost for this segment including the construction, right-of-way acquisition, construction management, contingencies, design and environmental is \$15.5 million. Shoreline's share of those costs is about 10%, which is at a level consistent with the City's leveraged

funding for the first two miles. The other 90% comes from Shoreline's funding partners on this project, including the federal government, the state and King County.

Weather permitting, construction is scheduled to begin this month and is expected to last a year with completion in winter 2012.

Improvements will be similar to those of the first and second mile. Included are wider sidewalks separated from the roadway by landscaping and other amenities, improved lighting and landscaped center medians with left- and U-turn pockets.

New to this segment of the Aurora Corridor Project are "green walls" and a plaza that will be located at the northeast corner of the King County

Metro Park & Ride on N 192nd Street. Green walls incorporate living elements such as climbing plants.

Due to the topography within this section of the corridor, retaining walls are necessary on both the east and west sides of Aurora. To help improve the appearance of these structures, the City has incorporated low-maintenance evergreen and deciduous plant species to grow on and cover some of the walls. At some locations, plants will grow up over steel mesh panels to add a three-dimensional aspect (see illustration above).

For more information visit shorelinewa.gov/Aurora or contact Capital Projects Manager John Vicente at (206) 801-2474, jvicente@shorelinewa.gov.

Shop Locally: Support Your Aurora Businesses!

Shoreline receives \$1.9 million for Aurora Corridor Project from PSRC

The Puget Sound Regional Council (PSRC) has awarded Shoreline the remaining \$1.9 million of the City's \$7.4 million request it made in 2009 for funds from the federal government's Congestion Mitigation and Air Quality (CMAQ) program for use on the Aurora Corridor Project.

PSRC awarded \$5.5 million to the City last year and the remaining \$1.9 million was placed on a contingency list of projects to receive funds as

they became available. The money is for the final segment of the Aurora Corridor Project running from N 192nd Street to N 205th Street.

Every two years, PSRC is responsible for distributing federal highway and transit funds under the CMAQ program. These funds are distributed through a competitive process. CMAQ funds are available for specific categories of transportation projects and programs that improve

air quality.

The cost to complete the N 192nd to N 205th Streets segment of Aurora is estimated to be between \$24 and \$31 million. To date, Shoreline has received approximately a quarter of the money needed from local, state and federal grants.

For more information, contact Transportation Services Manager Kirk McKinley at (206) 801-2481 or kmckinley@shorelinewa.gov.

Prepare for winter weather in Shoreline

Forecasters are predicting a colder and wetter than average winter for the Pacific Northwest. This means more rain, wind, ice and snow. Throughout the year, the City prepares for winter weather. The City asks residents to do the same.

Snow Removal

When it snows, City plows will concentrate their efforts on main roads (primary routes) first to accommodate fire, medical and police response, as well as Metro transit, school buses and commuter traffic. Primary routes include roads such as Aurora, 15th Avenue NE, N 155th, N 175th, N 185th and N 205th Streets. As long as it continues to snow, the City will only plow primary routes.

Once the snow has stopped and all primary routes are clear, plows will move to secondary roads. Once the secondary roads are cleared, plows

will move into neighborhoods.

If at any time it starts snowing again while plows are clearing secondary or neighborhood streets, the plows will return to the primary routes and the process of clearing streets will start over.

While the City will eventually get to all streets, it is possible that it might take several days after the final snow before residents may see a plow on their street. Snow plowing route maps are available to view at shorelinewa.gov.

Property Owner Responsibilities

Shoreline property owners are responsible for clearing snow and ice off driveways and sidewalks near their property, including the ridge of snow left along the edge of driveways by snow plows. The City will not plow driveways.

Property owners that plow snow or have it removed from their property should not place the snow in the public right-of-way. This is illegal and can lead to hazardous conditions for the traveling public. Property owners must accommodate removed snow on their own property or make arrangements to have the snow removed to another location.

Property owners should also help clear catch basins to make way for runoff from melting snow and avoid pooling water.

The City encourages residents to stay home during a heavy snow storm unless there is an emergency. If residents must travel, the City asks that they use public transportation whenever possible.

Garbage & Recycling Pick-up

Icy streets may prevent CleanScapes from collecting garbage and recycling on designated days. To learn more about its adverse weather and holiday policies, visit the website at cleanscapes.com or call (206) 763-4444.

Flood Preparedness

Another winter weather concern is flooding. Many parts of King County flood every year, including areas that have no history of floods. Preparing in advance will save you time and reduce risks to your family and property.

One of the most important things that you can do to help prevent flooding is to ensure storm drains remain clear in your neighborhood. Clearing leaves and debris from storm drains will reduce the risk of drainage problems.

Flood Insurance

Another way to protect your home is to purchase flood insurance. A standard homeowner insurance policy will not cover flood damage. However, all Shoreline residents are eligible for flood insurance. Contact your insurance agent or learn more about flood insurance at floodsmart.gov.

For more information on how to prepare for winter weather, visit the City's website.

Protect your pipes

Every winter, frozen pipes cause damage in homes, apartments and businesses. To avoid this from happening to you, keep your heat on at least 40 degrees, especially when on vacation. When frozen pipes thaw they cause cracks, floods, and numerous 9-1-1 calls.

Did you know?

Many salt-based products used to de-ice your driveway and sidewalks can kill vegetation and aquatic life, make your pet sick if ingested in large quantities and possibly irritate your pet's paws. Look for products that say pet-friendly or water safe. Typically, these contain more glycols, sugar and corn by-products. For more information, contact Environmental Programs Assistant Tina Han at (206) 801-2433 or than@shorelinewa.gov.

Healthy City Strategy

Stairs connector to the Interurban Trail at Echo Lake is complete

Another vital link in the City's pedestrian pathways system is open for use at Echo Lake. A staircase completes the connection between Aurora, the Echo Lake boardwalk at the south end of the lake and the Interurban Trail. The stairs have a wheel-channel to walk bicycles up or down. Directional signs will be coming in the near future.

The City coordinated the completion of the stairs with Inland Construction, Seattle City Light and the Echo Lake Neighborhood Association. Inland Construction paid for and built the stairs as part of project requirements. The stairs are located on Seattle City Light property, which meant the design required its approval.

The City sought to have a wheelchair ramp built instead of stairs. However, Seattle City Light felt that the construction of a wheelchair ramp could possibly destabilize the steep embankment. Wheelchair users can still use the sidewalk on N 192nd Street to travel between Aurora and the Interurban Trail.

The completion of the stairs provides another vital link in the City's pedestrian pathways system.

What makes Shoreline and its residents healthy? Obesity and its related diseases, such as diabetes, have significant impacts on the health of many communities in Washington and across the nation. However, through years of research the elements of a healthy community are well understood. They include:

1. Having access to and eating healthy foods.
2. Getting enough exercise.
3. Physically building a community that supports residents' exercise and walking.

The City is already doing a great deal in creating a physical environment that makes walking and exercise easier. Shoreline has extensive recreation offerings, ready access to parks and trails and land use plans that call for new developments to be pedestrian friendly. Other community organizations also offer opportunities for physical activity from

the Shoreline School District to sports leagues to the YMCA. Schools are also offering healthier food as compared to years past.

Even with all these opportunities there is still room for improvement to create a healthier place to raise children.

In October, City Council asked staff to assemble a team of community members and partner organizations to develop a Healthy City Strategy. The Strategy will outline a program of specific activities the City can undertake to support Shoreline residents in becoming healthier. The process will take place over the first half of 2011.

Visit the City's website to learn more about different healthy community strategies, such as First Lady Michelle Obama's Let's Move Initiative. For more information, contact Community Services Manager Rob Beem at (206) 801-2251 or rbeem@shorelinewa.gov.

Help keep bus stops and shelters in good condition: Report problems

The King County Metro Transit system is one of the largest transit systems in the nation and includes 9,200 bus stops and 1,568 bus shelters. Ensuring these bus stops and shelters are well maintained requires significant effort. Residents can help by reporting problems directly to Metro. To report problems such as graffiti, broken shelter glass and benches, excessive garbage, or damaged and missing transit signs call the Metro hotline at (206) 263-6369 or visit metro.kingcounty.gov/cs/FeedbackBusShelter.htm.





Our Shoreline

Share local photos with your Shoreline neighbors

Have you ever captured an amazing Shoreline image and wished you could show it to more people in the community? Whether your great Shoreline photos are of people, wildlife, landscapes or unique places, here's your opportunity to share them with the rest of Shoreline.

The City is looking for images that exemplify "Our Shoreline." Your "Our Shoreline" photos may fall into one or more categories including: People; Animals and Wildlife; Nature and Landscapes; and Places (examples include parks, trails or storefronts). Submitted photos may be featured in an issue of *Currents*, the *Parks and Recreation Guide*, the City's government access TV channel or the City's website.

To share an image, go to shorelinewa.gov/photos and use the upload tool.

Contact Communications Assistant Tavia Tan at ttan@shorelinewa.gov or (206) 801-2226 if you have questions or comments.



Our Shoreline Photos: Top is *X* by Dorrena Orteg ; left is *Echo Lake Fog* by Tom Downer; and immediately above is *Stoic Statue* by Nick Wishaar.



Changes to Public Comment Procedures

At its December 13 meeting, the Shoreline City Council adopted modifications to the Council Rules of Procedure relating to public comment during Council meetings.

All public comment will now be taken at the beginning of both study sessions and business meetings. Individuals may speak to agenda items or any other issue they wish.

The new rules have public comment at study sessions and business meetings mirror each other.

Use of public comment to promote or oppose any candidate for public office is still prohibited.

If you are unable to attend a council meeting, you may comment electronically on agenda items by submitting a comment form found on the Council agenda page of the City's website.

To learn more about public comment procedures at Council meetings and how to correspond with the Council in general, visit the City's website.

Keep dogs on leash or visit an off-leash area

Richmond Beach Saltwater Park Seasonal Dog Off-Leash Area, located at the south end of the beach, is open for seasonal use through March 15. The Shoreview Dog Off-Leash Area, located at 320 NW Innis Arden Way, is open year round.

To ensure dogs are leashed in the City's other parks, animal control officers patrol and issue citations. Please keep your dog on leash to avoid being cited.

New on the web:

- **Legal assistance page** – visit shorelinewa.gov/city attorney
- **Most visited City webpages** – under the Community tab
- **News about Shoreline** - under the Business/Economic Development tab

Your City Council wishes you a **Happy New Year!**



Front row, from left: Deputy Mayor Will Hall and Mayor Keith McGlashan. Back row, from left: Councilmembers Terry Scott, Doris McConnell, Chris Eggen, Shari Winstead and Chris Roberts.

Maintaining City roads

The largest and most valuable infrastructure asset the City of Shoreline owns is its streets. Maintaining a safe and reasonably good surface requires the City to constantly invest in its upkeep.

As with anything exposed to the elements, pavement quality will slowly deteriorate over time, reaching a point when it eventually has to be replaced. However, with proper maintenance, total replacement can be put off for years.

The recent price of oil has forced shortages in asphalt products with prices nearly doubling in just five years. In the past, the City had largely relied upon the use of thin asphalt overlays to maintain streets. This approach provided a relatively quick application along with added structural strength and a smooth riding surface. However, with limited funding and increasing costs, this approach is not financially sustainable.

In 2011, Shoreline will begin an extensive Bituminous Surface Treatment (BST) program where the City will be divided into approximately ten sections, with one section being treated each year. A more economical alternative to asphalt overlays, BST consists of aggregate (small rock) spread over rapidly setting asphalt solution and then rolled to lock it in place. Finally, a finely-sprayed asphalt product is applied to bind the surface.

Vehicles may drive on this initial application later that same day. The final sweeping and surface treatment happens a few days later. By using BSTs, the City is able to stretch its resources while still maintaining pavement quality.

For more information, contact Operations Manager Jesus Sanchez at (206) 801-2421 or jsanchez@shorelinewa.gov.

Upcoming Events

Monday, Jan. 12

Town Center Open House

Monday, Jan. 17

Martin Luther King, Jr. Day
City Hall and Pool closed

Tuesday, Jan. 18

City Council Meeting

Wednesday, Jan. 19

Surface Water Master Plan Update Open House

Thursday, Jan. 20

Planning Commission Meeting

Saturdays, Jan. 22 and 29

Bluff Restoration Work Parties
Richmond Beach Saltwater Park
2021 NW 190th Street

Tuesday, Jan. 25

Public Visioning Meeting for the Park at Towncenter

Thursday, Jan. 27

Park Board Meeting

Monday, Jan. 31

No Council Meeting - 5th Monday

Wednesday, Feb. 2

Council of Neighborhoods Meeting

Quick Start

Shoreline

Free Small Business Workshops

Tuesday, Jan. 18

Turn Limiting Beliefs into Empowering Beliefs

Tuesday, Jan. 25

Improve Your Bottom Line By Being Organized

Tuesday, Feb. 1

How to Earn More Profits by Communicating Differently

***All meetings located in City Hall Council Chambers unless otherwise noted.**



January 2011 Vol. 13 No. 1
CITY OF SHORELINE
CURRENTS

Currents is produced by the
 City Manager's Office,
 (206) 801-2217, ebratton@shorelinewa.gov
 Editing, writing and design:
 Eric Bratton, Tavia Tan and Susan Will.
 Photos: Adam Buchanan.

**Alternate formats
 available upon request**

 *Currents* is printed
 on post-consumer
 recycled paper with
 soy-based ink. 

We're on Facebook and YouTube!



17500 Midvale Avenue N.
 Shoreline, WA 98133-4921

Postmaster:
Time-Sensitive Material
Please deliver Jan. 3-5

PRSR STD
 US Postage
 PAID
 Seattle, WA
 Permit No. 248

ECRWSS
 POSTAL CUSTOMER

City of Shoreline

17500 Midvale Avenue N, Shoreline 98133
 (206) 801-2700 Fax (206) 546-7868
 shorelinewa.gov

Spartan Recreation Center
 202 NE 185th Street, Shoreline 98155
 (206) 801-2600 Fax (206) 393-3380

Shoreline Pool
 19030 1st Avenue NE, Shoreline 98155
 (206) 801-2650 Fax (206) 362-8450

Shoreline Police

Emergency: 911

Shoreline Police Station
 Chief Dan Pingrey
 1206 N 185th Street
 Shoreline, WA 98133
 (206) 801-2710

Eastside Police Neighborhood Center
 Officer Greg McKinney
 521 NE 165th Street
 Shoreline, WA 98155
 (206) 363-8424

Westside Police Neighborhood Center
 Officer Leona Obstler
 624 NW Richmond Beach Road
 Shoreline, WA 98177
 (206) 546-3636

shorelinewa.gov

Live and video archive meetings are
 available at shorelinewa.gov. Submit
 agenda item remarks online with the
 Comment Form on the Live & Video
 Council Meetings webpage.

Shoreline City Council

For all Councilmembers: (206) 801-2213, council@shorelinewa.gov



Mayor Keith McGlashan
 (206) 801-2203
 kmcglashan@shorelinewa.gov



Deputy Mayor Will Hall
 (206) 801-2207
 whall@shorelinewa.gov



Chris Eggen
 (206) 801-2206
 ceggen@shorelinewa.gov



Doris McConnell
 (206) 801-2204
 dmccConnell@shorelinewa.gov



Chris Roberts
 (206) 801-2205
 croberts@shorelinewa.gov



Terry Scott
 (206) 801-2202
 tscott@shorelinewa.gov



Shari Winstead
 (206) 801-2201
 swinstead@shorelinewa.gov

City Council Meetings

Shoreline City Hall, Council Chambers | Agenda Line: (206) 801-2236

Study Sessions: First and third Mondays 7:00 p.m.
 Business Meetings: Second and fourth Mondays 7:00 p.m.

Televised City Council Meetings
 Comcast Cable Channel 21 & Verizon Cable Channel 37
 Tuesday noon & 8:00 p.m., Wednesday - Sunday 6:00 a.m., noon & 8:00 p.m.